

AUCTION CATALOG – MARYSVILLE TOOLS & EQUIPMENT

Start Date: 10:00 AM | Friday – December 1st

End Date: 10:00 AM | Friday – December 8th

Preview 8:00 AM to 4:00 PM | Wednesday & Thursday, December 6th & 7th, 2023

3803 136th St NE – Marysville, WA 98271

13% BUYERS PREMIUM

ALL SALES FINAL UPON AWARD OF ONLINE BID

TERMS & CONDITIONS

PAYMENT:

FULL PAYMENT MUST BE MADE NO LATER THAN 5 PM, TUESDAY, DECEMBER 12TH. PAYMENT MUST BE MADE BY ONLINE CREDIT CARD OR WIRE TRANSFER ONLY. AFTER THE AUCTION CLOSES & YOU RECEIVE YOUR EMAILED INVOICE, PLEASE REPLY AND WE WILL CHARGE YOUR CARD ON FILE.

TO PAY ONLINE GO TO:

MURPHYAUCTION.COM/MAKEPAYMENT

WARRANTY DISCLAIMER:

ALL SALES ARE FINAL. ALL ITEMS ARE BEING SOLD "AS IS, WHERE IS", WITH ALL FAULTS AND WITHOUT ANY WARRANTIES AS TO MERCHANTABILITY OF FITNESS FOR A PARTICULAR PURPOSE. THE PRINCIPAL, THE AUCTIONEER, THE ADVERTISING COORDINATOR, AND ANY OF THEIR AGENTS MAKE NO EXPRESS OR IMPLIED WARRANTIES OF ANY TYPE.

ADVERTISING DISCLAIMER:

ALL INFORMATION WAS OBTAINED FROM SOURCES DEEMED RELIABLE. ALTHOUGH EVERY PRECAUTION HAS BEEN TAKEN TO ENSURE ACCURACY, THE PRINCIPAL, THE JAMES G. MURPHY CO., THE ADVERTISING COORDINATOR AND ALL THEIR AGENTS SHALL NOT BE RESPONSIBLE FOR ANY ERRORS OR OMISSIONS THEREIN. IT IS FOR THIS REASON THAT WE RECOMMEND THAT ALL ITEMS BE THOROUGHLY INSPECTED PRIOR TO THE POINT OF SALE.

REMOVAL:

ALL ITEMS MUST BE REMOVED NO LATER THAN 4:00 PM, WEDNESDAY, DECEMBER 20TH. REMOVAL HOURS: 8:00 AM TO 4:00 PM, MONDAY – FRIDAY, DECEMBER 11TH – 15TH AND MONDAY – WEDNESDAY, DECEMBER 18TH – 20TH. **NO REMOVAL UNTIL ALL ITEMS IN THE AUCTION HAVE CLOSED**ITEMS NOT REMOVED BY REMOVAL DEADLINE WILL BE CHARGED \$10/PER LOT PER DAY STORAGE FEES. NO SHIPPING OR WEEKEND REMOVAL** THERE IS A FORKLIFT AVAILABLE FOR REMOVAL.

ONLINE BIDS:

FAILURE TO AWARD BID - ONLINE BIDDERS WILL NOT HAVE ANY CLAIM AGAINST THE JAMES G. MURPHY CO. FOR FAILURE TO SUBMIT BIDS TO THE AUCTIONEER OR ANY ERROR ON THE BIDDING PLATFORM. IN SOME INSTANCES, THE BIDDING PLATFORM MAY SHOW AN ITEM AWARDED TO AN ONLINE CUSTOMER; HOWEVER, WE RESERVE THE RIGHT TO WITHDRAW A BID AWARDED IN ERROR.

SCAN THIS QR CODE FOR AUCTION CATALOG AND REGISTRATION



James G. Murphy Co.

Commercial & Industrial Auctioneers
425.486.1246 – murphyauction.com
PO BOX 1127, Marysville, WA 98270

AUCTION MAP

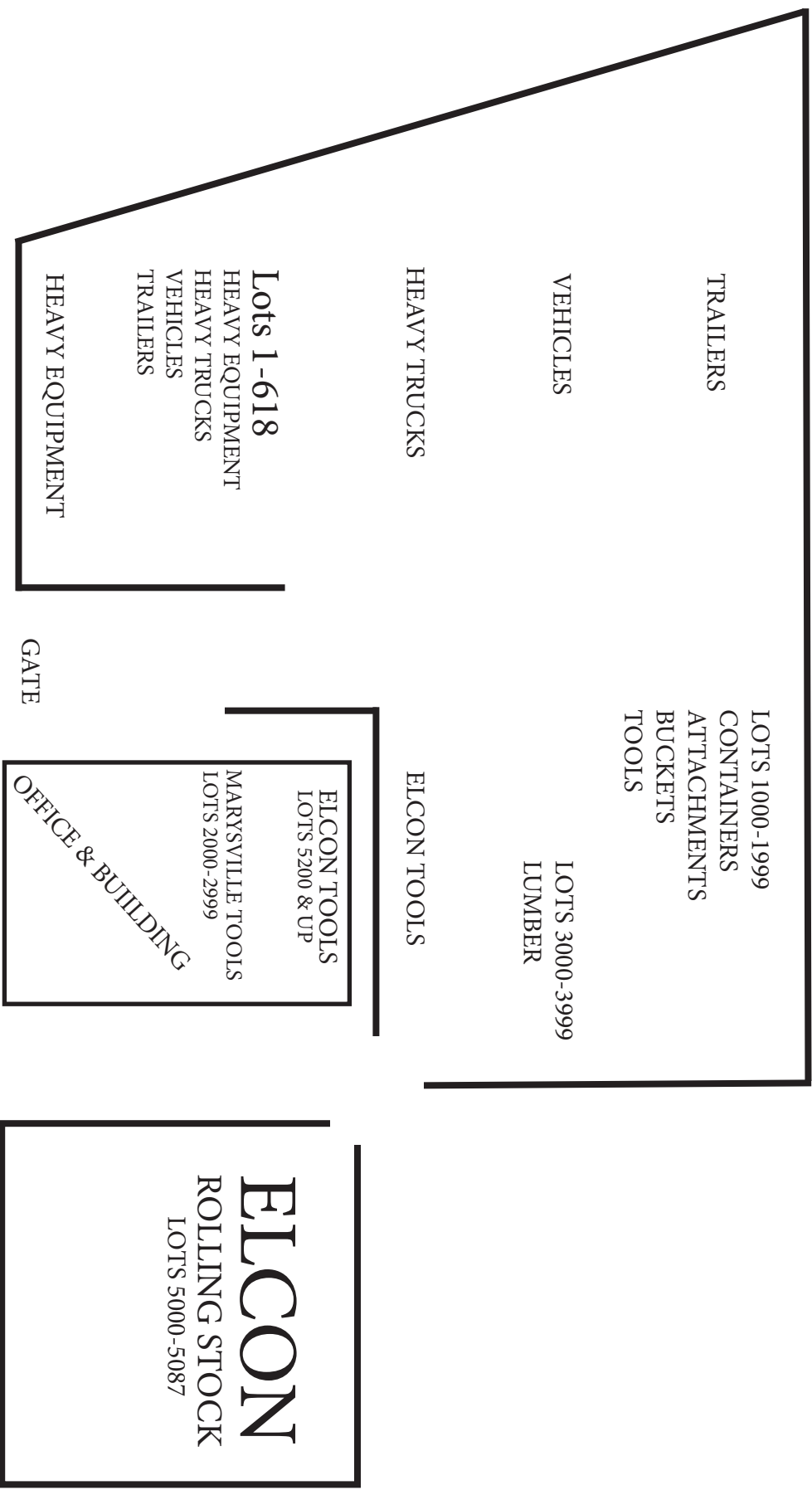

TRAILERS

VEHICLES

HEAVY TRUCKS

Lots 1-618

HEAVY EQUIPMENT
HEAVY TRUCKS
VEHICLES
TRAILERS

HEAVY EQUIPMENT

LOTS 1000-1999
CONTAINERS
ATTACHMENTS
BUCKETS
TOOLS

LOTS 3000-3999
LUMBER

ELCON TOOLS

ELCON TOOLS
LOTS 5200 & UP

MARYSVILLE TOOLS
LOTS 2000-2999

OFFICE & BUILDING

GATE

ELCON
ROLLING STOCK
LOTS 5000-5087



James G. Murphy Co.
PO BOX 1127
Marysville, WA 98270
Toll Free - 1.800.426.3008
murphyauction.com

MARYSVILLE TOOLS & EQUIPMENT - ONLINE ONLY 12/1/2023-12/8/2023

LOT #	LOT #
1000 40'L X 8'W X 9'6"H HIGH CUBE SHIPPING CONTAINER W/(4) DOUBLE SWING SIDE DOORS & DOUBLE SWING END DOORS (UNUSED, NO REMOVAL BEFORE THURSDAY, DECEMBER 14TH, PLEASE CALL TO SCHEDULE REMOVAL)	SWING END DOORS (UNUSED, NO REMOVAL BEFORE THURSDAY, DECEMBER 14TH, PLEASE CALL TO SCHEDULE REMOVAL)
1001 40'L X 8'W X 9'6"H HIGH CUBE SHIPPING CONTAINER W/(4) DOUBLE SWING SIDE DOORS & DOUBLE SWING END DOORS (UNUSED, NO REMOVAL BEFORE THURSDAY, DECEMBER 14TH, PLEASE CALL TO SCHEDULE REMOVAL)	1006 40'L X 8'W X 9'6"H HIGH CUBE SHIPPING CONTAINER W/(4) DOUBLE SWING SIDE DOORS & DOUBLE SWING END DOORS (UNUSED, NO REMOVAL BEFORE THURSDAY, DECEMBER 14TH, PLEASE CALL TO SCHEDULE REMOVAL)
1002 40'L X 8'W X 9'6"H HIGH CUBE SHIPPING CONTAINER W/(4) DOUBLE SWING SIDE DOORS & DOUBLE SWING END DOORS (UNUSED, NO REMOVAL BEFORE THURSDAY, DECEMBER 14TH, PLEASE CALL TO SCHEDULE REMOVAL)	1007 40'L X 8'W X 9'6"H HIGH CUBE SHIPPING CONTAINER W/(4) DOUBLE SWING SIDE DOORS & DOUBLE SWING END DOORS (UNUSED, NO REMOVAL BEFORE THURSDAY, DECEMBER 14TH, PLEASE CALL TO SCHEDULE REMOVAL)
1003 40'L X 8'W X 9'6"H HIGH CUBE SHIPPING CONTAINER W/(4) DOUBLE SWING SIDE DOORS & DOUBLE SWING END DOORS (UNUSED, NO REMOVAL BEFORE THURSDAY, DECEMBER 14TH, PLEASE CALL TO SCHEDULE REMOVAL)	1008 40'L X 8'W X 9'6"H HIGH CUBE SHIPPING CONTAINER W/(4) DOUBLE SWING SIDE DOORS & DOUBLE SWING END DOORS (FLOOR DAMAGE, UNUSED, NO REMOVAL BEFORE THURSDAY, DECEMBER 14TH, PLEASE CALL TO SCHEDULE REMOVAL)
1004 40'L X 8'W X 9'6"H HIGH CUBE SHIPPING CONTAINER W/(4) DOUBLE SWING SIDE DOORS & DOUBLE SWING END DOORS (FLOOR DAMAGE, UNUSED, NO REMOVAL BEFORE THURSDAY, DECEMBER 14TH, PLEASE CALL TO SCHEDULE REMOVAL)	1009 40'L X 8'W X 9'6"H HIGH CUBE SHIPPING CONTAINER W/(4) DOUBLE SWING SIDE DOORS & DOUBLE SWING END DOORS (UNUSED, NO REMOVAL BEFORE THURSDAY, DECEMBER 14TH, PLEASE CALL TO SCHEDULE REMOVAL)
1005 40'L X 8'W X 9'6"H HIGH CUBE SHIPPING CONTAINER W/(4) DOUBLE SWING SIDE DOORS & DOUBLE	1010 40'L X 8'W X 9'6"H HIGH CUBE SHIPPING CONTAINER W/(4) DOUBLE SWING SIDE DOORS & DOUBLE SWING END DOORS (UNUSED, NO REMOVAL BEFORE THURSDAY, DECEMBER 14TH, PLEASE CALL TO SCHEDULE REMOVAL)

****13% BUYERS PREMIUM ON ALL ITEMS****

MARYSVILLE TOOLS & EQUIPMENT - ONLINE ONLY 12/1/2023-12/8/2023

LOT #	LOT #
<p>1011 40'L X 8'W X 9'6"H HIGH CUBE SHIPPING CONTAINER</p> <p>W/(4) DOUBLE SWING SIDE DOORS & DOUBLE SWING END DOORS (UNUSED, NO REMOVAL BEFORE THURSDAY, DECEMBER 14TH, PLEASE CALL TO SCHEDULE REMOVAL)</p>	<p>BEFORE THURSDAY, DECEMBER 14TH, PLEASE CALL TO SCHEDULE REMOVAL)</p>
<p>1012 40'L X 8'W X 9'6"H HIGH CUBE SHIPPING CONTAINER</p> <p>W/(2) DOUBLE SWING SIDE DOORS & DOUBLE SWING END DOORS (UNUSED, NO REMOVAL BEFORE THURSDAY, DECEMBER 14TH, PLEASE CALL TO SCHEDULE REMOVAL)</p>	<p>1014 40'L X 8'W X 9'6"H HIGH CUBE SHIPPING A CONTAINER</p> <p>W/(2) DOUBLE SWING SIDE DOORS & DOUBLE SWING END DOORS (UNUSED, NO REMOVAL BEFORE THURSDAY, DECEMBER 14TH)</p>
<p>1013 40'L X 8'W X 9'6"H HIGH CUBE SHIPPING CONTAINER</p> <p>W/(2) DOUBLE SWING SIDE DOORS & DOUBLE SWING END DOORS (UNUSED, NO REMOVAL BEFORE THURSDAY, DECEMBER 14TH, PLEASE CALL TO SCHEDULE REMOVAL)</p>	<p>1014B 40'L X 8'W X 9'6"H HIGH CUBE SHIPPING CONTAINER</p> <p>W/(2) DOUBLE SWING SIDE DOORS & DOUBLE SWING END DOORS (UNUSED, NO REMOVAL BEFORE THURSDAY, DECEMBER 14TH)</p>
<p>1013 40'L X 8'W X 9'6"H HIGH CUBE SHIPPING CONTAINER</p> <p>W/(2) DOUBLE SWING SIDE DOORS & DOUBLE SWING END DOORS (UNUSED, NO REMOVAL BEFORE THURSDAY, DECEMBER 14TH, PLEASE CALL TO SCHEDULE REMOVAL)</p>	<p>1014 40'L X 8'W X 9'6"H HIGH CUBE SHIPPING C CONTAINER</p> <p>W/(2) DOUBLE SWING SIDE DOORS & DOUBLE SWING END DOORS (UNUSED, NO REMOVAL BEFORE THURSDAY, DECEMBER 14TH)</p>
<p>1013B 40'L X 8'W X 9'6"H HIGH CUBE SHIPPING CONTAINER</p> <p>W/(4) DOUBLE SWING SIDE DOORS & DOUBLE SWING END DOORS (UNUSED, NO REMOVAL BEFORE THURSDAY, DECEMBER 14TH)</p>	<p>1014 40'L X 8'W X 9'6"H HIGH CUBE SHIPPING D CONTAINER</p> <p>W/(4) DOUBLE SWING SIDE DOORS & DOUBLE SWING END DOORS (UNUSED, NO REMOVAL BEFORE THURSDAY, DECEMBER 14TH)</p>
<p>1013 40'L X 8'W X 9'6"H HIGH CUBE SHIPPING C CONTAINER</p> <p>W/(4) DOUBLE SWING SIDE DOORS & DOUBLE SWING END DOORS (UNUSED, NO REMOVAL BEFORE THURSDAY, DECEMBER 14TH)</p>	<p>1015 40'L X 8'W X 9'6"H HIGH CUBE REFRIGERATED</p> <p>SHIPPING CONTAINER W/DAIKIN LXE10E-A15J REFRIGERATION UNIT & DOUBLE SWING END DOORS (NO REMOVAL BEFORE THURSDAY, DECEMBER 14TH, PLEASE CALL TO SCHEDULE REMOVAL)</p>
<p>1013 40'L X 8'W X 9'6"H HIGH CUBE SHIPPING D CONTAINER</p> <p>W/(4) DOUBLE SWING SIDE DOORS & DOUBLE SWING END DOORS (UNUSED, NO REMOVAL BEFORE THURSDAY, DECEMBER 14TH)</p>	<p>1016 40'L X 8'W X 9'6"H HIGH CUBE REFRIGERATED</p> <p>SHIPPING CONTAINER W/CARRIER TRANSICOLD 69NT40-5H-201 REFRIGERATION UNIT & DOUBLE SWING END DOORS (NO REMOVAL BEFORE THURSDAY, DECEMBER 14TH, PLEASE CALL TO SCHEDULE REMOVAL)</p>
<p>1014 40'L X 8'W X 9'6"H HIGH CUBE SHIPPING CONTAINER</p> <p>W/(2) DOUBLE SWING SIDE DOORS & DOUBLE SWING END DOORS (UNUSED, NO REMOVAL</p>	

MARYSVILLE TOOLS & EQUIPMENT - ONLINE ONLY 12/1/2023-12/8/2023

LOT #	LOT #
<p>1017 40'L X 8'W X 9'6"H HIGH CUBE REFRIGERATED</p> <p>SHIPPING CONTAINER W/CARRIER TRANSICOLD REFRIGERATION UNIT & DOUBLE SWING END DOORS (NO REMOVAL BEFORE THURSDAY, DECEMBER 14TH, PLEASE CALL TO SCHEDULE REMOVAL)</p>	<p>1023 10'L X 7'W X 8'H PORTABLE OFFICE CONTAINER W/SIDE DOOR, WINDOW, DOUBLE SWING END DOORS & FORK POCKETS (MEASUREMENTS ARE APPROX, NO REMOVAL BEFORE THURSDAY, DECEMBER 14TH)</p>
<p>1018 40'L X 8'W X 9'6"H HIGH CUBE REFRIGERATED</p> <p>SHIPPING CONTAINER W/DOUBLE SWING END DOORS (MISSING REFRIGERATION UNIT, NO REMOVAL BEFORE THURSDAY, DECEMBER 14TH, PLEASE CALL TO SCHEDULE REMOVAL)</p>	<p>1024 9'L X 7'W X 8'H PORTABLE OFFICE CONTAINER W/SIDE DOOR, WINDOW, DOUBLE SWING END DOORS & FORK POCKETS (MEASUREMENTS ARE APPROX, NO REMOVAL BEFORE THURSDAY, DECEMBER 14TH)</p>
<p>1019 45'L X 8'W X 9'6"H HIGH CUBE SHIPPING CONTAINER</p> <p>W/DOUBLE SWING END DOORS (NO REMOVAL BEFORE THURSDAY, DECEMBER 14TH, PLEASE CALL TO SCHEDULE REMOVAL)</p>	<p>1025 9'L X 7'W X 8'H PORTABLE OFFICE CONTAINER W/SIDE DOOR, WINDOW, DOUBLE SWING END DOORS & FORK POCKETS (MEASUREMENTS ARE APPROX, NO REMOVAL BEFORE THURSDAY, DECEMBER 14TH)</p>
<p>1020 40'L X 8'W X 9'6"H HIGH CUBE REFRIGERATED</p> <p>SHIPPING CONTAINER W/CARRIER 69NT40-511-201 TRANSICOLD REFRIGERATION UNIT & DOUBLE SWING END DOORS (NO REMOVAL BEFORE THURSDAY, DECEMBER 14TH, PLEASE CALL TO SCHEDULE REMOVAL)</p>	<p>1026 9'L X 7'W X 8'H PORTABLE OFFICE CONTAINER W/SIDE DOOR, WINDOW, DOUBLE SWING END DOORS & FORK POCKETS (MEASUREMENTS ARE APPROX)</p>
<p>1021 40'L X 8'W X 9'6"H HIGH CUBE REFRIGERATED</p> <p>SHIPPING CONTAINER W/CARRIER 69NT40-511-101 TRANSICOLD REFRIGERATION UNIT & DOUBLE SWING END DOORS (NO REMOVAL BEFORE THURSDAY, DECEMBER 14TH, PLEASE CALL TO SCHEDULE REMOVAL)</p>	<p>1027 9'L X 7'W X 8'H PORTABLE OFFICE CONTAINER W/SIDE DOOR, WINDOW, DOUBLE SWING END DOORS & FORK POCKETS (MEASUREMENTS ARE APPROX)</p>
<p>1022 12'L X 7'W X 8'H LIGHT GAUGE STEEL PORTABLE</p> <p>OFFICE CONTAINER W/SIDE DOOR, WINDOW, DOUBLE SWING END DOORS & FORK POCKETS (MEASUREMENTS ARE APPROX)</p>	<p>1028 8'L X 6'6"W X 7'6" PORTABLE OFFICE CONTAINER</p> <p>W/SIDE DOOR, WINDOW, DOUBLE SWING END DOORS & FORK POCKETS (MEASUREMENTS ARE APPROX)</p>
	<p>1029 8'L X 6'6"W X 7'H PORTABLE OFFICE CONTAINER</p> <p>W/SIDE DOOR, WINDOW, DOUBLE SWING END DOORS & FORK POCKETS (MEASUREMENTS ARE APPROX)</p>
	<p>1030 8'L X 6'6"W X 7'H PORTABLE OFFICE CONTAINER</p> <p>W/SIDE DOOR, WINDOW, DOUBLE SWING END DOORS & FORK POCKETS (MEASUREMENTS ARE APPROX)</p>

MARYSVILLE TOOLS & EQUIPMENT - ONLINE ONLY 12/1/2023-12/8/2023

LOT #	LOT #
<p>1031 8'L X 6'6"W X 7'6"H PORTABLE OFFICE CONTAINER</p> <p>W/SIDE DOOR, WINDOW, DOUBLE SWING END DOORS & FORK POCKETS (MEASUREMENTS ARE APPROX)</p>	<p>1039 20'L X 7'W X 8'H PORTABLE OFFICE W/TOILET,</p> <p>SHOWER, SINK & FILE CABINET (UNUSED, NO REMOVAL BEFORE THURSDAY, DECEMBER 14TH)</p>
<p>1032 7'L X 6'W X 6'6"H PORTABLE OFFICE CONTAINER</p> <p>W/SIDE DOOR, WINDOW, DOUBLE SWING END DOORS & FORK POCKETS (MEASUREMENTS ARE APPROX)</p>	<p>1040 BASTONE</p> <p>20'L X 7'W X 8'H PREFAB TINY CUBE W/TOILET, SHOWER, SINK, BED & FORK POCKETS (UNUSED, NO REMOVAL BEFORE THURSDAY, DECEMBER 14TH)</p>
<p>1033 7'L X 6'W X 6'6"H PORTABLE OFFICE CONTAINER</p> <p>W/SIDE DOOR, WINDOW, DOUBLE SWING END DOORS & FORK POCKETS (MEASUREMENTS ARE APPROX)</p>	<p>1041 BASTONE</p> <p>13'L X 7'W X 8'H PREFAB TINY CUBE W/TOILET, SHOWER, SINK, BED & FORK POCKETS (UNUSED, NO REMOVAL BEFORE THURSDAY, DECEMBER 14TH)</p>
<p>1034 12'L X 7'W X 8'H PORTABLE OFFICE CONTAINER W/SIDE DOOR, WINDOW, DOUBLE SWING END DOORS & FORK POCKETS (MEASUREMENTS ARE APPROX)</p>	<p>1042 CHERY INDUSTRIAL</p> <p>20'L X 7'W X 8'6"H PORTABLE EXPANDABLE HOUSE W/SLIDING DOOR & KITCHEN (UNUSED, NO REMOVAL BEFORE THURSDAY, DECEMBER 14TH)</p>
<p>1035 9'L X 7'W X 8'H PORTABLE OFFICE CONTAINER W/SIDE DOOR, WINDOW, DOUBLE SWING END DOORS & FORK POCKETS (MEASUREMENTS ARE APPROX)</p>	<p>1044 HOS HF1</p> <p>19' FOLDING STORAGE BUILDING (UNUSED, NO REMOVAL BEFORE THURSDAY, DECEMBER 14TH)</p>
<p>1036 9'L X 7'W X 8'H PORTABLE OFFICE CONTAINER W/SIDE DOOR, WINDOW, DOUBLE SWING END DOORS & FORK POCKETS (MEASUREMENTS ARE APPROX)</p>	<p>1045 HOS HF1</p> <p>19' FOLDING STORAGE BUILDING (UNUSED, NO REMOVAL BEFORE THURSDAY, DECEMBER 14TH)</p>
<p>1037 8'L X 7'W X 7'6"H PORTABLE OFFICE CONTAINER</p> <p>W/SIDE DOOR, WINDOW, DOUBLE SWING END DOORS & FORK POCKETS (MEASUREMENTS ARE APPROX)</p>	<p>1046 HOS HF1</p> <p>19' FOLDING STORAGE BUILDING (UNUSED, NO REMOVAL BEFORE THURSDAY, DECEMBER 14TH)</p>
<p>1038 8'L X 7'W X 7'6"H PORTABLE OFFICE CONTAINER</p> <p>W/SIDE DOOR, WINDOW, DOUBLE SWING END DOORS & FORK POCKETS (MEASUREMENTS ARE APPROX)</p>	<p>1047 HOS HF1</p> <p>19' FOLDING STORAGE BUILDING (UNUSED, NO REMOVAL BEFORE THURSDAY, DECEMBER 14TH)</p>
	<p>1048 HOS HF1</p> <p>19' FOLDING STORAGE BUILDING (UNUSED, NO REMOVAL BEFORE THURSDAY, DECEMBER 14TH)</p>

13% BUYERS PREMIUM ON ALL ITEMS

MARYSVILLE TOOLS & EQUIPMENT - ONLINE ONLY 12/1/2023-12/8/2023

LOT #	LOT #
1049 HOS HF1	1100 78" HYDRAULIC SKID STEER HEAVY GRASS FORK GRAPPLE ATTACHMENT (UNUSED)
19' FOLDING STORAGE BUILDING (UNUSED, NO REMOVAL BEFORE THURSDAY, DECEMBER 14TH)	
1050 HOS HF2L	1101 78" HYDRAULIC SKID STEER HEAVY GRASS FORK GRAPPLE ATTACHMENT (UNUSED)
20'L X 7'W X 8'H EXPANDABLE HOUSE (UNUSED, NO REMOVAL BEFORE THURSDAY, DECEMBER 14TH)	
1051 HOS HF2L	1102 78" HYDRAULIC SKID STEER HEAVY GRASS FORK GRAPPLE ATTACHMENT (UNUSED)
20'L X 7'W X 8'H EXPANDABLE HOUSE (UNUSED, NO REMOVAL BEFORE THURSDAY, DECEMBER 14TH)	
1052 HOS HF2L	1103 82" HYDRAULIC SKID STEER GRAPPLE BUCKET ATTACHMENT (UNUSED)
20'L X 7'W X 8'H LIGHT GAUGE STEEL EXPANDABLE HOUSE (UNUSED, NO REMOVAL BEFORE THURSDAY, DECEMBER 14TH)	
1053 HOS HF2L	1104 82" HYDRAULIC SKID STEER GRAPPLE BUCKET ATTACHMENT (UNUSED)
20'L X 7'W X 8'H LIGHT GAUGE STEEL EXPANDABLE HOUSE (UNUSED, BATHROOM DOOR DAMAGED, NO REMOVAL BEFORE THURSDAY, DECEMBER 14TH)	
1054 12'L X 7'W X 8'H MULTI-FUNCTION MOBILE OFFICE W/TOILET, SHOWER, SINK, WINDOWS & FOLDING SOFA BED (UNUSED, BROKEN WINDOW, NO REMOVAL BEFORE THURSDAY, DECEMBER 14TH)	1105 AGT PD750-PZ
	HYDRAULIC SKID STEER POST DRIVER ATTACHMENT (UNUSED)
1055 AAR MOBILITY SYSTEMS EISU90	1106 AGT PD750-PZ
7'L X 9'W X 7'6" H PORTABLE EXPANDABLE SHOWER SYSTEM W/FORK POCKETS	HYDRAULIC SKID STEER POST DRIVER ATTACHMENT (UNUSED)
1098 BASTONE	1107 AGT EXFLM115
10'L X 8'W X 7'6"H ROCK SCREEN (UNUSED)	48" HYDRAULIC EXCAVATOR BRUSH FLAIL MOWER ATTACHMENT (UNUSED)
1099 68"L X 83"W X 97"H VIBRATORY SCREEN W/ELECTRIC MOTOR, 460V (UNUSED)	1108 AGT EXFLM115
	48" HYDRAULIC EXCAVATOR BRUSH FLAIL MOWER ATTACHMENT (UNUSED)
	1109 TOPCAT BDRC
	48" HYDRAULIC SKID STEER ADJUSTABLE SWING MOWER ATTACHMENT (UNUSED)

MARYSVILLE TOOLS & EQUIPMENT - ONLINE ONLY 12/1/2023-12/8/2023

<u>LOT #</u>	<u>LOT #</u>
1110 TOPCAT BDRC	1121 MOWER KING SSRC
48" HYDRAULIC SKID STEER ADJUSTABLE SWING MOWER ATTACHMENT (UNUSED)	72" HYDRAULIC SKID STEER BRUSH CUTTER ATTACHMENT (UNUSED)
1111 TOPCAT 4IN1BCT	1122 MOWER KING SSRC
75" HYDRAULIC SKID STEER 4 IN 1 BUCKET ATTACHMENT (UNUSED)	72" HYDRAULIC SKID STEER BRUSH CUTTER ATTACHMENT (UNUSED)
1112 TOPCAT ECSSRB	1123 MOWER KING SSRC
HYDRAULIC SKID STEER TREE SHEAR ATTACHMENT (UNUSED)	72" HYDRAULIC SKID STEER BRUSH CUTTER ATTACHMENT (UNUSED)
1113 78" HYDRAULIC SKID STEER HEAVY GRASS FORK GRAPPLE ATTACHMENT (UNUSED)	1124 HYDRAULIC SKID STEER BACKHOE ARM DIGGING
	ATTACHMENT (UNUSED)
1114 78" HYDRAULIC SKID STEER HEAVY GRASS FORK GRAPPLE ATTACHMENT (UNUSED)	1125 HYDRAULIC SKID STEER AUGER ATTACHMENT W/9", 12" & 18" AUGER BITS (UNUSED)
1115 78" HYDRAULIC SKID STEER HEAVY GRASS FORK GRAPPLE ATTACHMENT (UNUSED)	1126 HYDRAULIC SKID STEER AUGER ATTACHMENT W/9", 12" & 18" AUGER BITS (UNUSED)
1116 78" HYDRAULIC SKID STEER HEAVY GRASS FORK GRAPPLE ATTACHMENT (UNUSED)	1127 HYDRAULIC SKID STEER AUGER ATTACHMENT W/9", 12" & 18" AUGER BITS (UNUSED)
1117 78" HYDRAULIC SKID STEER HEAVY GRASS FORK GRAPPLE ATTACHMENT (UNUSED)	1128 HYDRAULIC SKID STEER AUGER ATTACHMENT W/9", 12" & 18" AUGER BITS (UNUSED)
1118 78" HYDRAULIC SKID STEER HEAVY GRASS FORK GRAPPLE ATTACHMENT (UNUSED)	1129 AGT SSECAG-Y
1119 MOWER KING SSRC	HYDRAULIC SKID STEER HEAVY DUTY AUGER ATTACHMENT W/6", 12" & 14" AUGER BITS (UNUSED)
72" HYDRAULIC SKID STEER BRUSH CUTTER ATTACHMENT (UNUSED)	
1120 MOWER KING SSRC	
72" HYDRAULIC SKID STEER BRUSH CUTTER ATTACHMENT (UNUSED)	

MARYSVILLE TOOLS & EQUIPMENT - ONLINE ONLY 12/1/2023-12/8/2023

LOT #	LOT #
1130 AGT SSECAG-Y	1138 MOWER KING SSECAG-Y
HYDRAULIC SKID STEER HEAVY DUTY AUGER ATTACHMENT W/6", 12" & 14" AUGER BITS (UNUSED)	HYDRAULIC SKID STEER HEAVY DUTY AUGER ATTACHMENT W/6", 12" & 14" AUGER BITS (UNUSED)
1131 AGT SSECAG-Y	1139 MOWER KING SSECAG-Y
HYDRAULIC SKID STEER HEAVY DUTY AUGER ATTACHMENT W/6", 12" & 14" AUGER BITS (UNUSED)	HYDRAULIC SKID STEER HEAVY DUTY AUGER ATTACHMENT W/6", 12" & 14" AUGER BITS (UNUSED)
1132 AGT SSECAG-Y	1140 MOWER KING SSECAG-Y
HYDRAULIC SKID STEER HEAVY DUTY AUGER ATTACHMENT W/6", 12" & 14" AUGER BITS (UNUSED)	HYDRAULIC SKID STEER HEAVY DUTY AUGER ATTACHMENT W/6", 12" & 14" AUGER BITS (UNUSED)
1133 AGT SSECAG-Y	1141 TOPCAT SSSG72
HYDRAULIC SKID STEER HEAVY DUTY AUGER ATTACHMENT W/6", 12" & 14" AUGER BITS (UNUSED)	72" HYDRAULIC SKID STEER GRADER BLADE ATTACHMENT (UNUSED)
1134 AGT SSECAG-Y	1142 TOPCAT ECSSLR72
HYDRAULIC SKID STEER HEAVY DUTY AUGER ATTACHMENT W/6", 12" & 14" AUGER BITS (UNUSED)	72" HYDRAULIC SKID STEER POWER RAKE ATTACHMENT (UNUSED)
1135 AGT SSECAG-Y	1143 MOWER KING SSRC
HYDRAULIC SKID STEER HEAVY DUTY AUGER ATTACHMENT W/6", 12" & 14" AUGER BITS (UNUSED)	72" HYDRAULIC SKID STEER BRUSH CUTTER ATTACHMENT (UNUSED)
1136 AGT SSECAG-Y	1144 MOWER KING SSRC
HYDRAULIC SKID STEER HEAVY DUTY AUGER ATTACHMENT W/6", 12" & 14" AUGER BITS (UNUSED)	72" HYDRAULIC SKID STEER BRUSH CUTTER ATTACHMENT (UNUSED)
1137 MOWER KING SSECAG-Y	1145 MOWER KING SSRC
HYDRAULIC SKID STEER HEAVY DUTY AUGER ATTACHMENT W/6", 12" & 14" AUGER BITS (UNUSED)	72" HYDRAULIC SKID STEER BRUSH CUTTER ATTACHMENT (UNUSED)
	1146 MOWER KING SSRC
	72" HYDRAULIC SKID STEER BRUSH CUTTER ATTACHMENT (UNUSED)

MARYSVILLE TOOLS & EQUIPMENT - ONLINE ONLY 12/1/2023-12/8/2023

LOT #	LOT #
1147 MOWER KING SSRC	1156 BOBCAT 709
72" HYDRAULIC SKID STEER BRUSH CUTTER ATTACHMENT (UNUSED)	HYDRAULIC SKID STEER BACKHOE ATTACHMENT (NO REMOVAL BEFORE THURSDAY, DECEMBER 14TH)
1148 GIYI	1157 5'W FORK ATTACHMENT (NO REMOVAL BEFORE THURSDAY, DECEMBER 14TH)
EXCAVATOR RIPPER ATTACHMENT (UNUSED, FITS CAT 336)	
1149 GIYI	1158 PSM
EXCAVATOR RIPPER ATTACHMENT (UNUSED, FITS CAT 320)	9'W FORK ATTACHMENT (NO REMOVAL BEFORE THURSDAY, DECEMBER 14TH)
1150 GIYI	1159 HALTON
EXCAVATOR RIPPER ATTACHMENT (UNUSED, FITS CAT 320)	8'W HYDRAULIC GRAPPLE FORK ATTACHMENT (FITS CAT 980-G-H, NO REMOVAL BEFORE THURSDAY, DECEMBER 14TH)
1151 HYDRAULIC SKID STEER HEAVY GRASS FORK GRAPPLE	1160 PSM MPCT-32176A
ATTACHMENT (UNUSED)	10'W 3.5 CU YD HYDRAULIC 4-IN-1 BUCKET (FITS CAT 950, NO REMOVAL BEFORE THURSDAY, DECEMBER 14TH)
1152 HYDRAULIC SKID STEER HEAVY GRASS FORK GRAPPLE	1161 ESCO
ATTACHMENT (UNUSED)	36" DIGGING BUCKET (NO REMOVAL BEFORE THURSDAY, DECEMBER 14TH)
1153 HYDRAULIC SKID STEER HEAVY GRASS FORK GRAPPLE	1162 CRAIG GP-542-1.5
ATTACHMENT (UNUSED)	38" DIGGING BUCKET (NO REMOVAL BEFORE THURSDAY, DECEMBER 14TH)
1154 HYDRAULIC SKID STEER TREE SHEAR GRAPPLE	1163 GIYI
ATTACHMENT (UNUSED, NO REMOVAL BEFORE THURSDAY, DECEMBER 14TH)	40"W DIGGING BUCKET (FITS CAT 320, UNUSED, NO REMOVAL BEFORE THURSDAY, DECEMBER 14TH)
1155 DIGGIT TH76	1164 CRAIG HD-542-1.5
76" HYDRAULIC SKID STEER FORESTRY DRUM MULCHER ATTACHMENT (UNUSED, NO REMOVAL BEFORE THURSDAY, DECEMBER 14TH)	38"W DIGGING BUCKET (NO REMOVAL BEFORE THURSDAY, DECEMBER 14TH)

MARYSVILLE TOOLS & EQUIPMENT - ONLINE ONLY 12/1/2023-12/8/2023

LOT #	LOT #
1165 40" DIGGING BUCKET (NO REMOVAL BEFORE THURSDAY, DECEMBER 14TH)	1176 LOT, MIVA MINI EXCAVATOR ATTACHMENT SET (UNUSED)
1166 CWS 120-36 PC DIG 32" Q/C DIGGING BUCKET (FITS KOMATSU PC138, NO REMOVAL BEFORE THURSDAY, DECEMBER 14TH)	1177 LOT, MIVA MINI EXCAVATOR ATTACHMENT SET (UNUSED)
1167 WAIN RAY 16" DIGGING BUCKET (NO REMOVAL BEFORE THURSDAY, DECEMBER 14TH)	1178 LOT, MIVA MINI EXCAVATOR ATTACHMENT SET (UNUSED)
1168 HPF 24" Q/C DIGGING BUCKET (NO REMOVAL BEFORE THURSDAY, DECEMBER 14TH)	1179 LOT, MIVA MINI EXCAVATOR ATTACHMENT SET (UNUSED)
1169 CWS 120-60 PG GU 56" Q/C CLEANOUT BUCKET (FITS KOMATSU PC138, NO REMOVAL BEFORE THURSDAY, DECEMBER 14TH)	1180 LOT, MIVA MINI EXCAVATOR ATTACHMENT SET (UNUSED)
1170 PSM 48" Q/C CLEANOUT BUCKET (FITS JD/HITACHI 50 MINI, NO REMOVAL BEFORE THURSDAY, DECEMBER 14TH)	1181 LOT, MIVA MINI EXCAVATOR ATTACHMENT A SET (UNUSED)
1171 36" CLEANOUT BUCKET (FITS DITCHWITCH)	1181BLOT,MIVA MINI EXCAVATOR ATTACHMENT SET (UNUSED)
1172 10" Q/C DIGGING BUCKET W/CLEANOUT EDGE (FITS KOMATSU 275R)	1182 LOT, MIVA MINI EXCAVATOR HYDRAULIC AUGER ATTACHMET W/8", 12" & 16" AUGER BITS (UNUSED)
1173 LOT, MIVA MINI EXCAVATOR ATTACHMENT SET (UNUSED)	1183 LOT, MIVA MINI EXCAVATOR HYDRAULIC AUGER ATTACHMET W/8", 12" & 16" AUGER BITS (UNUSED)
1174 LOT, MIVA MINI EXCAVATOR ATTACHMENT SET (UNUSED)	1184 LOT, MIVA MINI EXCAVATOR HYDRAULIC AUGER ATTACHMET W/8", 12" & 16" AUGER BITS (UNUSED)
1175 LOT, MIVA MINI EXCAVATOR ATTACHMENT SET (UNUSED)	1185 LOT, MIVA MINI EXCAVATOR HYDRAULIC AUGER ATTACHMET W/8", 12" & 16" AUGER BITS (UNUSED)
	1186 MIVA 12" MINI EXCAVATOR HYDRAULIC AUGER ATTACHMENT (UNUSED)

MARYSVILLE TOOLS & EQUIPMENT - ONLINE ONLY 12/1/2023-12/8/2023

<u>LOT #</u>	<u>LOT #</u>
1187 MIVA	1197 18" AUGER BIT
16" MINI EXCAVATOR HYDRAULIC AUGER ATTACHMENT (UNUSED)	
1188 MIVA	1198 AGT EXRC-54
16" MINI EXCAVATOR HYDRAULIC AUGER ATTACHMENT (UNUSED)	54" HYDRAULIC EXCAVATOR BRUSH CUTTER ATTACHMENT (UNUSED)
1189 MIVA	1199 AGT EXRC-54
12" MINI EXCAVATOR HYDRAULIC AUGER ATTACHMENT (UNUSED)	54" HYDRAULIC EXCAVATOR BRUSH CUTTER ATTACHMENT (UNUSED)
1190 MIVA	1200 AGT SSVR72
12" MINI EXCAVATOR HYDRAULIC AUGER ATTACHMENT (UNUSED)	72" HYDRAULIC SKID STEER VIBRATORY ROLLER ATTACHMENT (UNUSED)
1191 MIVA	1201 AGT SSAB-72
12" MINI EXCAVATOR HYDRAULIC AUGER ATTACHMENT (UNUSED)	HYDRAULIC SKID STEER ROTARY ANGLE BROOM ATTACHMENT (UNUSED)
1192 MIVA	1202 MOWER KING SSBX42
12" MINI EXCAVATOR HYDRAULIC AUGER ATTACHMENT (UNUSED)	HYDRAULIC SKID STEER WOOD CHIPPER ATTACHMENT (UNUSED)
1193 MIVA	1203 MOWER KING SSBX42
12" MINI EXCAVATOR HYDRAULIC AUGER ATTACHMENT (UNUSED)	HYDRAULIC SKID STEER WOOD CHIPPER ATTACHMENT (UNUSED)
1194 MIVA	1204 HYDRAULIC SKID STEER TIRE GRABBER (UNUSED)
12" MINI EXCAVATOR HYDRAULIC AUGER ATTACHMENT (UNUSED)	
1195 MIVA	1205 HYDRAULIC SKID STEER LOGGING WINCH ATTACHMENT (UNUSED)
24" MINI EXCAVATOR HYDRAULIC CLEANOUT BUCKET (UNUSED)	
1196 LOT, MIVA MINI EXCAVATOR HYDRAULIC THUMBS, RAKES & RIPPER (UNUSED)	1207 86" HYDRAULIC SKID STEER SNOW PLOW BLADE ATTACHMENT (UNUSED)

13% BUYERS PREMIUM ON ALL ITEMS

MARYSVILLE TOOLS & EQUIPMENT - ONLINE ONLY 12/1/2023-12/8/2023

<u>LOT #</u>	<u>LOT #</u>
1208 FORKLIFT JIB ATTACHMENT (UNUSED)	1219 SKID STEER HYDRAULIC BALE CLAMP (UNUSED)
1209 FORKLIFT JIB ATTACHMENT (UNUSED)	1220 70" SKID STEER HYDRAULIC BOX GRADER ATTACHMENT (UNUSED)
1210 72" HYDRAULIC SKID STEER SKELETON GRAPPLE BUCKET ATTACHMENT (UNUSED)	1221 70" SKID STEER HYDRAULIC BOX GRADER ATTACHMENT (UNUSED)
1211 66" HYDRAULIC SKID STEER BRUSH CUTTER ATTACHMENT (UNUSED)	1222 KUBOTA LAS34 FRONT END HYDRAULIC LOADER ATTACHMENT W/60" BUCKET
1212 TOPCAT SS5G72 72" HYDRAULIC SKID STEER GRADER BLADE ATTACHMENT	1223 WB 48" EXCAVATOR GRAPPLE (DAMAGED)
1213 86" SKID STEER HYDRAULIC SNOW PLOW BLADE ATTACHMENT (UNUSED)	1224 AGT SSHH680 SKID STEER HYDRAULIC HAMMER ATTACHMENT (UNUSED)
1214 6' SKID STEER HYDRAULIC POWER RAKE W/REMOTE PENDANT (UNUSED)	1225 AGT SSHH680 SKID STEER HYDRAULIC HAMMER ATTACHMENT (UNUSED)
1215 SKID STEER HYDRAULIC TREE SHEAR W/GRAPPLE ATTACHMENT (UNUSED)	1226 AGT SA-AD SKID STEER HYDRAULIC FORKLIFT MAST ATTACHMENT W/48" FORKS
1216 72" SKID STEER HYDRAULIC ROTARY CULTIVATOR ATTACHMENT (UNUSED)	1227 AGT SA-AD SKID STEER HYDRAULIC FORKLIFT MAST ATTACHMENT W/48" FORKS
1217 78" SKID STEER HYDRAULIC GRAPPLE ATTACHMENT (UNUSED)	1228 AGT SAII100 SKID STEER FORKLIFT MAST W/48" FORKS (UNUSED)
1218 78" SKID STEER HYDRAULIC GRAPPLE ATTACHMENT (UNUSED)	

13% BUYERS PREMIUM ON ALL ITEMS

MARYSVILLE TOOLS & EQUIPMENT - ONLINE ONLY 12/1/2023-12/8/2023

LOT #	LOT #
1229 AGT SAH100	1240 BOBCAT 72 SWEEPER
SKID STEER FORKLIFT MAST W/48" FORKS (UNUSED)	72" SKID STEER HYDRAULIC ROTARY BROOM ATTACHMENT (NO REMOVAL BEFORE THURSDAY, DECEMBER 14TH)
1230 AGT SAH100	1241 BOBCAT 72 SWEEPER
SKID STEER FORKLIFT MAST W/48" FORKS (UNUSED)	72" SKID STEER HYDRAULIC ROTARY BROOM ATTACHMENT (NO REMOVAL BEFORE THURSDAY, DECEMBER 14TH)
1231 AGT SAH100	1242 QUICK ATTACH ATTACHMENTS, 72" SKID STEER
SKID STEER FORKLIFT MAST W/48" FORKS (UNUSED)	HYDRAULIC POWER RAKE ATTACHMENT (NO REMOVAL BEFORE THURSDAY, DECEMBER 14TH)
1232 AGT SAH100	1243 LAND PRIDE
SKID STEER FORKLIFT MAST W/48" FORKS (UNUSED)	10' 3 PT PTO DRIVEN MOWER DECK ATTACHMENT (NO REMOVAL BEFORE THURSDAY, DECEMBER 14TH)
1233 AGT SAH100	1244 NORMET CH150
SKID STEER FORKLIFT MAST W/48" FORKS (UNUSED)	3 PT PTO DRIVEN CHIPPER ATTACHMENT (NO REMOVAL BEFORE THURSDAY, DECEMBER 14TH)
1234 AGT SAH100	1245 JRB
SKID STEER FORKLIFT MAST W/48" FORKS (UNUSED)	Q/C BUCKET ATTACHMENT (FITS HITACHI 450)
1235 AGT SAH100	1246 43" X 34" HYDRAULIC PLATE COMPACTOR ATTACHMENT
SKID STEER FORKLIFT MAST W/48" FORKS (UNUSED)	(20" PIN CENTERS)
1236 LOT, (2) 48" FORKS (1 PAIR)	1247 BTI TC92V
1237 LOT, (2) 48" FORKS (1 PAIR, FITS HYSTER 120)	24" X 36" HYDRAULIC PLATE COMPACTOR ATTACHMENT (12" PIN CENTERS)
1238 JET CITY EQUIPMENT	1248 HS-600
SKID STERE FORKLIFT MAST W/48" FORKS	30" X 23" HYDRAULIC PLATE COMPACTOR ATTACHMENT (14" PIN CENTERS)
1239 ALITEC SG40BE	
SKID STEER HYDRAULIC STUMP GRINDER ATTACHMENT (NO REMOVAL BEFORE THURSDAY, DECEMBER 14TH)	

13% BUYERS PREMIUM ON ALL ITEMS

MARYSVILLE TOOLS & EQUIPMENT - ONLINE ONLY 12/1/2023-12/8/2023

LOT #	LOT #
1249 EGN EG750	1259 40" X 40" SELF-DUMPING HOPPER W/FORK POCKETS
7.5 HP TRACKED REMOTE CONTROL CRAWLER LAWN MOWER W/LONCIN 196CC GAS ENGINE (UNUSED)	(UNUSED)
1250 EGN EG750	1260 40" X 40" SELF-DUMPING HOPPER W/FORK POCKETS
7.5 HP TRACKED REMOTE CONTROL CRAWLER LAWN MOWER W/LONCIN 196CC GAS ENGINE (UNUSED)	(UNUSED)
1251 LOT, 3-PC MINI EXCAVATOR ATTACHMENT SET (3-3/8" PIN CENTERS, UNUSED)	1261 40" X 40" SELF-DUMPING HOPPER W/FORK POCKETS
	(UNUSED)
1252 SDLOOL SL90B	1262 40" X 40" SELF-DUMPING HOPPER W/FORK POCKETS
21" X 19" WALK-BEHIND PLATE COMPACTOR W/LONCIN 196CC GAS ENGINE (UNUSED)	(UNUSED)
1253 SDLOOL SL90B	1263 40" X 40" SELF-DUMPING HOPPER W/FORK POCKETS
21" X 19" WALK-BEHIND PLATE COMPACTOR W/LONCIN 196CC GAS ENGINE (UNUSED)	(UNUSED)
1254 SDLOOL SL80LC	1264 40" X 40" SELF-DUMPING HOPPER W/FORK POCKETS
4 HP JUMPING JACK W/JINHE 170 GAS ENGINE (UNUSED)	(UNUSED)
1255 SDLOOL SL80LC	1265 GREATBEAR
4 HP JUMPING JACK W/JINHE 170 GAS ENGINE (UNUSED)	14' BI-PARTING WROUGHT IRON GATE (UNUSED)
1256 FORD SUPER DUTY 8' TRUCK BED W/BUMPER & BACKUP CAMERA	1266 GREATBEAR
	14' BI-PARTING WROUGHT IRON GATE (UNUSED)
1257 40" X 40" SELF-DUMPING HOPPER W/FORK POCKETS	1267 LOT, (5) 14' BI-PARTING WROUGHT IRON GATES
(UNUSED)	(UNUSED, NO REMOVAL BEFORE THURSDAY, DECEMBER 14TH)
1258 40" X 40" SELF-DUMPING HOPPER W/FORK POCKETS	1268 LOT, (5) 20' BI-PARTING WROUGHT IRON GATES
(UNUSED)	(UNUSED, NO REMOVAL BEFORE THURSDAY,

13% BUYERS PREMIUM ON ALL ITEMS

MARYSVILLE TOOLS & EQUIPMENT - ONLINE ONLY 12/1/2023-12/8/2023

LOT #	LOT #
DECEMBER 14TH)	1277 LOT, (4) APPROX 18'L X 42"W PALLET RACKING
-----	UPRIGHTS & (12) 8'L PALLET RACKING CROSSMEMBERS IN THIS STACK
1269 LOT, (5) 20' BI-PARTING WROUGHT IRON GATES	-----
(UNUSED, NO REMOVAL BEFORE THURSDAY, DECEMBER 14TH)	1278 LOT, (4) APPROX 20'L X 42"W PALLET RACKING
-----	UPRIGHTS & (12) 8'L PALLET RACKING CROSSMEMBERS IN THIS STACK
1270 LOT, (3) STEELMAN TM18-NCC 20' X 7" FARM METAL DRIVEWAY GATES (UNUSED, NO REMOVAL BEFORE THURSDAY, DECEMBER 14TH)	-----
-----	1279 HENRY INDUSTRIAL
1271 16' ELECTRONIC ACTUATED BI-PARTING GATE W/KEYS, 24V (UNUSED, NO REMOVAL BEFORE THURSDAY, DECEMBER 14TH)	79" X 5' ELECTRIC SHAKER SCREEN W/FORK POCKETS, 380-415V
-----	-----
1272 16' ELECTRONIC ACTUATED BI-PARTING GATE W/KEYS, 24V (UNUSED, NO REMOVAL BEFORE THURSDAY, DECEMBER 14TH)	1280 TMG INDUSTRIAL TMG-RSV70G
-----	6' X 4' VIBRATORY SHAKER SCREEN W/KOHLER 5.5 HP GAS ENGINE & FORK POCKETS
1273 LOT, (4) APPROX 18'L X 42"W PALLET RACKING	-----
UPRIGHTS & (12) 8'L PALLET RACKING CROSSMEMBERS IN THIS STACK	1281 PAIR OF 25"W STEEL TRACKS (FITS CAT D3 LGP)
-----	-----
1274 LOT, (4) APPROX 18'L X 42"W PALLET RACKING	1282 SKID STEER MOUNT ATTACHMENT
UPRIGHTS & (12) 8'L PALLET RACKING CROSSMEMBERS IN THIS STACK	-----
-----	1283 WEST COAST FOOTINGS RED MASTER HARROW
1275 LOT, (4) APPROX 18'L X 42"W PALLET RACKING	94"W 3-PT HARROW ATTACHMENT
UPRIGHTS & (12) 8'L PALLET RACKING CROSSMEMBERS IN THIS STACK	-----
-----	1284 LEOCERING TRAIL BLAZERS
1276 LOT, (4) APPROX 18'L X 42"W PALLET RACKING	14' TIRE CRAWLER TRACK
UPRIGHTS & (12) 8'L PALLET RACKING CROSSMEMBERS IN THIS STACK	-----
-----	1285 ERIEZ 18X96
-----	ROAD SWEEPER MAGNET ATTACHMENT
-----	-----
-----	1286 LOT, APPROX (82) 80"L X 4'H SECTIONS OF METAL PERIMETER FENCE PANELS IN THIS STACK (UNUSED, NO REMOVAL BEFORE THURSDAY, DECEMBER 14TH)

MARYSVILLE TOOLS & EQUIPMENT - ONLINE ONLY 12/1/2023-12/8/2023

LOT #	LOT #
1287 LOT, APPROX (82) 80"L X 4'H SECTIONS OF METAL PERIMETER FENCE PANELS IN THIS STACK (UNUSED, NO REMOVAL BEFORE THURSDAY, DECEMBER 14TH)	1296 LOT, APPROX (20) FENS FEN20 10'L X 7'H GALVANIZED STEEL FENCE PANELS W/POSTS (UNUSED)
1288 LOT, APPROX (56) 112"L X 5'H POWDER COATED CORRAL PANELS (UNUSED, NO REMOVAL BEFORE THURSDAY, DECEMBER 14TH)	1297 LOT, APPROX (20) FENS FEN20 10'L X 7'H GALVANIZED STEEL FENCE PANELS W/POSTS (UNUSED)
1289 LOT, APPROX (56) 112"L X 5'H CORRAL PANELS (UNUSED, NO REMOVAL BEFORE THURSDAY, DECEMBER 14TH)	1298 LOT, APPROX (20) FENS FEN20 10'L X 7'H GALVANIZED STEEL FENCE PANELS W/POSTS (UNUSED)
1290 LOT, APPROX (14) 116"L X 93"H CORRAL PANEL GATES (UNUSED, NO REMOVAL BEFORE THURSDAY, DECEMBER 14TH)	1299 LOT, APPROX (20) FENS FEN20 10'L X 7'H GALVANIZED STEEL FENCE PANELS W/POSTS (UNUSED)
1291 LOT, APPROX (40) 7'L X 7'H 2-RAIL WROUGHT IRON SITE FENCEING W/POSTS (UNUSED, NO REMOVAL BEFORE THURSDAY, DECEMBER 14TH)	1300 LOT, APPROX (30) 10'L X 7'H WROUGHT IRON SITE FENCING PANELS W/POSTS (UNUSED)
1292 LOT, APPROX (40) 7'L X 7'H 2-RAIL WROUGHT IRON SITE FENCEING W/POSTS (UNUSED, NO REMOVAL BEFORE THURSDAY, DECEMBER 14TH)	1301 LOT, APPROX (30) 10'L X 7'H WROUGHT IRON SITE FENCING PANELS W/POSTS (UNUSED)
1293 LOT, APPROX (45) FENS FES45 GALVANIZED STEEL FENCE PANELS W/POSTS (NO REMOVAL BEFORE THURSDAY, DECEMBER 14TH)	1302 LOT, APPROX (20) FENS FEN20 10'L X 7'H GALVANIZED STEEL FENCE PANELS W/POSTS (UNUSED)
1294 LOT, APPROX (20) FENS FEN20 10'L X 7'H GALVANIZED STEEL FENCE PANELS W/POSTS (DAMAGED, UNUSED)	1303 LOT, APPROX (20) FENS FEN20 10'L X 7'H GALVANIZED STEEL FENCE PANELS W/POSTS (UNUSED)
1295 LOT, APPROX (20) FENS FEN20 10'L X 7'H GALVANIZED STEEL FENCE PANELS W/POSTS (UNUSED)	1304 LOT, APPROX (20) FENS FEN20 10'L X 7'H GALVANIZED STEEL FENCE PANELS W/POSTS (UNUSED)
	1305 LOT, APPROX (20) FENS FEN20 10'L X 7'H GALVANIZED STEEL FENCE PANELS W/POSTS (UNUSED)
	1306 LOT, APPROX (20) FENS FEN20 10'L X 7'H GALVANIZED STEEL FENCE PANELS W/POSTS (UNUSED)
	1307 LOT, APPROX (20) FENS FEN20 10'L X 7'H GALVANIZED STEEL FENCE PANELS W/POSTS (UNUSED)

MARYSVILLE TOOLS & EQUIPMENT - ONLINE ONLY 12/1/2023-12/8/2023

LOT #	LOT #
1308 LOT, APPROX (30) SUIHE 10'L X 7'H 4-RAIL	1319 BASTONE
GALVANIZED STEEL GARDEN/PUBLIC SPACE FENCE PANELS W/POSTS (UNUSED)	85"L X 75"W X 93"H MOBILE RESTROOM W/TOILET, SHOWER, SINK, LIGHT, FAN & FORK POCKETS, 110/220V (UNUSED)
1309 LOT, APPROX (30) SUIHE 10'L X 7'H 4-RAIL	1320 BASTONE
GALVANIZED STEEL GARDEN/PUBLIC SPACE FENCE PANELS W/POSTS (UNUSED)	81"L X 50"W X 90"H 2-STALL MOBILE RESTROOM W/TOILET, SINK, FAN & FORK POCKETS, 110/220V (UNUSED)
1310 LOT, AGT 10FWIF24 114" X 77"H STEEL FENCE PANELS W/POSTS (UNUSED)	1321 BASTONE
1311 LOT, APPROX (45) FENS FES45 6'L X 5'H GALVANIZED	85"L X 63"W X 90"H MOBILE RESTROOM W/TOILET, SHOWER, SINK, WINDOW, FAN & FORK POCKETS, 110/220V (UNUSED)
STEEL FENCE PANELS W/POSTS (UNUSED)	1322 BASTONE
1312 LOT, APPROX (20) 10'L X 6'H PORTABLE CONSTRUCTION	81"L X 50"W X 90"H 2-STALL MOBILE RESTROOM W/TOILET, SINK, FAN & FORK POCKETS, 110/220V (UNUSED)
FENCING W/BASES (UNUSED)	1323 BASTONE
1313 LOT, APPROX (60) 7'L X 4'H HIP-DOT GALVANIZED	85"L X 75"W X 93"H MOBILE RESTROOM W/TOILET, SHOWER, SINK, WINDOW, FAN & FORK POCKETS, 110/220V (UNUSED)
FENCE PANELS W/POSTS (UNUSED)	1324 48"L X 43"W X 97"H MOBILE RESTROOM W/TOILET & FAN, 110V (UNUSED)
1314 LOT, APPROX (60) 7'L X 4'H HIP-DOT GALVANIZED	1324B 48"L X 43"W X 97"H MOBILE RESTROOM W/TOILET & FAN, 110V (UNUSED)
FENCE PANELS W/POSTS (UNUSED)	1325 HOS HSML
1315 LOT, (3) STEELMAN 20'L X 7'H FARM METAL DRIVEWAY GATE SETS, (3) LEFT & (3) RIGHT (UNUSED)	43"L X 43"W X 92"H MOBILE RESTROOM W/TOILET, SINK & FAN, 110V (UNUSED)
1316 PAIR OF 9'4"L X 6"W FORK EXTENSIONS (UNUSED)	1325BHOS HSML
1317 PAIR OF 9'4"L X 6"W FORK EXTENSIONS (UNUSED)	43"L X 43"W X 92"H MOBILE RESTROOM W/TOILET, SINK & FAN, 110V (UNUSED)
1318 8' HYDRAULIC SKID STEER GRADER ATTACHMENT (UNUSED)	

13% BUYERS PREMIUM ON ALL ITEMS

MARYSVILLE TOOLS & EQUIPMENT - ONLINE ONLY 12/1/2023-12/8/2023

LOT #	LOT #
1326 80"L X 76"W X 93"H MOBILE RESTROOM W/TOILET, SHOWER, SINK & FAN, 110/220V (UNUSED)	1336 7' 10-DRAWER WORKBENCH (UNUSED)
1327 7'L X 4'W X 8'H 2-STALL MOBILE RESTROOM W/TOILET & FAN, 110V (UNUSED)	1337 7' 10-DRAWER WORKBENCH (UNUSED)
1328 HOS HSM2 81"L X 42"W X 92"H 2-STALL MOBILE RESTROOM W/TOILET, SINK, FAN, 110V (UNUSED)	1338 7' 10-DRAWER WORKBENCH (UNUSED)
1329 85"L X 63"W X 90"H MOBILE RESTROOM W/TOILET, SHOWER, SINK, FAN & FORK POCKETS, 110V (UNUSED, NO REMOVAL BEFORE THURSDAY, DECEMBER 14TH)	1339 7' 10-DRAWER WORKBENCH (UNUSED)
1330 HOS HSM2 83"L X 43"W X 92"H 2-STALL MOBILE RESTROOM W/TOILET, SINK & FAN, 110V (NO REMOVAL BEFORE THURSDAY, DECEMBER 14TH)	1340 TMG INDUSTRIAL TMG-WB5S 85" SS WORKBENCH (UNUSED)
1331 85"L X 59"W X 8'H MOBILE RESTROOM W/TOILET, SHOWER, SINK & FAN, 110V (UNUSED, NO REMOVAL BEFORE THURSDAY, DECEMBER 14TH)	1341 TMG INDUSTRIAL TMG-WB5S 85" SS WORKBENCH (UNUSED)
1332 85"L X 59"W X 8'H MOBILE RESTROOM W/TOILET, SHOWER, SINK & FAN, 110V (UNUSED, NO REMOVAL BEFORE THURSDAY, DECEMBER 14TH)	1342 TMG INDUSTRIAL TMG-WB5S 85" SS WORKBENCH (UNUSED)
1334 STEELMAN 10FT-18D 10', 18-DRAWER WORKBENCH (UNUSED)	1343 TMG INDUSTRIAL TMG-WBC07 10' 30-DRAWER WORKBENCH (UNUSED)
1335 STEELMAN 10FT-18D 10', 18-DRAWER WORKBENCH (UNUSED)	1344 TMG INDUSTRIAL TMG-WBC07 10' 30-DRAWER WORKBENCH (UNUSED)
	1345 TMG INDUSTRIAL TMG-WBC07 7' HEAVY DUTY STEEL GARAGE WORKBENCH (UNUSED)
	1346 TMG INDUSTRIAL TMG-WBC07 7' HEAVY DUTY STEEL GARAGE WORKBENCH (UNUSED)
	1347 TMG INDUSTRIAL TMG-WBC20D 10' 20-DRAWER WORKBENCH CABINET COMBO W/SS DRAWER PANELS (UNUSED)
	1348 TMG INDUSTRIAL TMG-SC22DS 26" X 88.5" X 87" 22-DRAWER STAINLESS STORAGE CHEST (UNUSED)

MARYSVILLE TOOLS & EQUIPMENT - ONLINE ONLY 12/1/2023-12/8/2023

<u>LOT #</u>	<u>LOT #</u>
1349 TMG INDUSTRIAL TMG-WB20DS 10' 20-DRAWER STAINLESS WORKBENCH (UNUSED)	1361 STEELMAN 7FT-20D-01B 7', 20-DRAWER WORKBENCH (UNUSED)
1350 TMG INDUSTRIAL TMG-WB20DS 10' 20-DRAWER STAINLESS WORKBENCH (UNUSED)	1362 9', 30-DRAWER WORKBENCH (UNUSED)
1351 TMG INDUSTRIAL TMG-SC35D 85", 35-DRAWER TOOL STORAGE CHEST (UNUSED)	1363 9', 30-DRAWER WORKBENCH (UNUSED)
1352 TMG INDUSTRIAL TMG-SC35D 85", 35-DRAWER TOOL STORAGE CHEST (UNUSED)	1364 9', 30-DRAWER WORKBENCH (UNUSED)
1353 TMG INDUSTRIAL TMG-SC80 80", 12-DRAWER TOOL STORAGE CHEST (UNUSED)	1365 STEELMAN 7FT-35D-01B 7', 35-DRAWER WORKBENCH (UNUSED)
1354 TMG INDUSTRIAL TMG-SC80 80", 12-DRAWER TOOL STORAGE CHEST (UNUSED)	1366 STEELMAN 7FT-35D-01B 7', 35-DRAWER WORKBENCH (UNUSED)
1355 TMG INDUSTRIAL TMG-SC88 88", 16-DRAWER TOOL STORAGE CHEST (UNUSED)	1367 STEELMAN 7FT-35D-01B 7', 35-DRAWER WORKBENCH (UNUSED)
1356 TMG INDUSTRIAL TMG-SC88 88", 16-DRAWER TOOL STORAGE CHEST (UNUSED)	1368 STEELMAN 7FT-18HD 7', 18-DRAWER WORKBENCH (UNUSED)
1357 STEELMAN 10FT-30D 10', 30-DRAWER WORKBENCH (UNUSED)	1369 STEELMAN 7FT-18HD 7', 18-DRAWER WORKBENCH (UNUSED)
1358 STEELMAN 10FT-30D 10', 30-DRAWER WORKBENCH (UNUSED)	1370 STEELMAN 7FT-18HD 7', 18-DRAWER WORKBENCH (UNUSED)
1359 STEELMAN 7FT-20D-01B 7', 20-DRAWER WORKBENCH (UNUSED)	1371 112", 30-DRAWER, 2-CABINET WORKBENCH
1360 STEELMAN 7FT-20D-01B 7', 20-DRAWER WORKBENCH (UNUSED)	1372 STEELMAN 7FT-20D-01B 7', 20-DRAWER WORKBENCH (UNUSED)
	1373 STEELMAN 7FT-20D-01B 7', 20-DRAWER WORKBENCH (UNUSED)
	1374 LOT, (1) 75-GAL & (1) UNKNOWN CAP ALUMINUM FUEL TANKS ON THIS PALLET (75-GAL IS MISSING PLUGS & UNKNOWN CAP TANK IS DAMAGED)

13% BUYERS PREMIUM ON ALL ITEMS

MARYSVILLE TOOLS & EQUIPMENT - ONLINE ONLY 12/1/2023-12/8/2023

<u>LOT #</u>	<u>LOT #</u>
1375 LOT, ASSORTED TIRE CHAINS ON THIS PALLET	1385 GOLDEN MOUNT C2020 20' X 20' X 6.5' PE FABRIC BUILDING (UNUSED)
1376 GENIE GS-1930 19' 500 LB 24V SCISSOR LIFT, HOUR METER READS: 00277 SERIAL NUMBER: GS30058-07603	1386 TMG INDUSTRIAL TMG-ST2031P 20' X 30' ARCH WALL PEAK CEILING STORAGE SHELTER (UNUSED)
1376B GENIE GS-1930 19', 500 LB CAP, 24V SCISSOR LIFT, HOUR METER READS: 161	1387 AGT INDUSTRIAL ST3065V 65' X 30' X 15' PEAK CEILING STORAGE BUILDING (UNUSED)
1377 6' X 5' STEEL DOCK RAMP	1388 AGT INDUSTRIAL ST4040C 40' X 40' X 12' PEAK ROOF CONTAINER SHELTER (UNUSED)
1378 AGT ATK-B1000 8,800 LB CAP 2-POST AUTOMOTIVE LIFT (UNUSED)	1389 GOLDEN MOUNT S203012R 30'L X 20'W X 12'R PE FABRIC BUILDING (UNUSED)
1379 AGT ATK-B1000 8,800 LB CAP 2-POST AUTOMOTIVE LIFT (UNUSED)	1390 GOLDEN MOUNT S203012R 30'L X 20'W X 12'R PE FABRIC BUILDING (UNUSED)
1380 TMG INDUSTRIAL TMG-RS10 10' X 7' HEAVY DUTY ADJUSTABLE ROCK SCREENER (UNUSED)	1391 GOLDEN MOUNT S203012R 30'L X 20'W X 12'R PE FABRIC BUILDING (UNUSED)
1381 PROTECH 86" DIAMOND PLATE ALUMINUM CAB GUARD	1392 GOLDEN MOUNT S203012R 30'L X 20'W X 12'R PE FABRIC BUILDING (UNUSED)
1382 LOT, (2) TUFFY 19" X 64.5" X 7" ALUMINUM TOOL STORAGE CABINETS ON THIS PALLET (NO KEYS, MISSING (1) LOCK MECH)	1393 GOLDEN MOUNT S203012R 30'L X 20'W X 12'R PE FABRIC BUILDING (UNUSED)
1383 LOT, (3) 5.5" X 40" X 86" STEEL DOOR FRAMS W/DOORS ON THIS PALLET (MEASUREMENTS ARE APPROX)	1394 GOLDEN MOUNT C2020 20'L X 20'W X 6.5'H PE FABRIC CONTAINER SHELTER (UNUSED)
1384 HITACHI EQUIPMENT CAB SHELL	1395 GOLDEN MOUNT C2020 20'L X 20'W X 6.5'H PE FABRIC CONTAINER SHELTER (UNUSED)

13% BUYERS PREMIUM ON ALL ITEMS

MARYSVILLE TOOLS & EQUIPMENT - ONLINE ONLY 12/1/2023-12/8/2023

LOT #	LOT #
1396 GOLDEN MOUNT C2020 20'L X 20'W X 6.5'H PE FABRIC CONTAINER SHELTER (UNUSED)	1406 LOT, (250) STEELMAN PVC SAFETY TRAFFIC CONES (UNUSED)
1397 GOLDEN MOUNT C2040 40'L X 20'W X 6.5'H PE FABRIC CONTAINER SHELTER (UNUSED)	1407 LOT, VEHICLE BUMPERS & (1) TRUNK ON THIS PALLET
1398 GOLDEN MOUNT C2040 40'L X 20'W X 6.5'H PE FABRIC CONTAINER SHELTER (UNUSED)	1409 AUTOMOTIVE SEAT ON THIS PALLET
1399 GOLDEN MOUNT C2040 40'L X 20'W X 6.5'H PE FABRIC CONTAINER SHELTER (UNUSED)	1410 CARGO GLIDE CG1000XL TRUCK BED CARGO SLIDE
1400 GOLDEN MOUNT C2040 40'L X 20'W X 6.5'H PE FABRIC CONTAINER SHELTER (UNUSED)	1411 LOT, (2) 108" X 20" X 8" SERVICE BOX ACCESSORIES
1401 TMG INDUSTRIAL TMG HW41T 4,000 PSI HOT WATER PRESSURE WASHER, KOHLER COMMAND PRO GAS ENGINE W/245-GAL WATER TANK (UNUSED)	1412 LOT, (3) FORD SUPER DUTY TAILGATES ON THIS PALLET
1402 LOT, (250) TRAFFIC SAFETY CONES (UNUSED)	1413 LOT, ASSORTED TIRE CHAINS ON THIS PALLET
1403 LOT, (250) TRAFFIC SAFETY CONES (UNUSED)	1414 LOT, (3) 24" STEEL RIMS ON THIS PALLET
1404 LOT, AGT INDUSTRIAL T-TOP BOLLARD & WARNING BUNDING, (100) BOLLARD, (100) BASES & (50) BUNTING UNITS, (UNUSED)	1415 LOT, (2) 24" ALUMINUM RIMS ON THIS PALLET
1405 LOT, (250) AGT INDUSTRIAL 75CM PE REFLECTIVE TRAFFIC CONES (UNUSED)	1416 LOT, 6" SCHEDULE 80 RIDGID PVC CONDUIT SECTIONS ON THIS PALLET
	1417 LOT, ASSORTED SIZE GEOPLAST GEOTUBE ROUND COLUMN REUSABLE FORMWORK W/PINS ON THESE (4) PALLETS
	1421 GARDNER DENVER RNC125A1 COMPRESSED AIR DRYER, 115V
	1422 ADVANTAGE LIFT SYSTEMS ALS-50XX 50,000 LB CAP DRIVE ON AUTO LIFT W/CONTROL MODULE
	1426 TMG INDUSTRIAL TMG-GLS34 34-TON TOW BEHIND LOG SPLITTER W/KOHLER CH270 7 HP GAS ENGINE (UNUSED, NO REMOVAL)

13% BUYERS PREMIUM ON ALL ITEMS

MARYSVILLE TOOLS & EQUIPMENT - ONLINE ONLY 12/1/2023-12/8/2023

LOT #	LOT #
BEFORE THURSDAY, DECEMBER 14TH)	1435 TMG INDUSTRIAL TMG-SP50
1427 TMG INDUSTRIAL TMG-GLS34	50-TON HYDRAULIC SHOP PRESS (UNUSED, NO REMOVAL BEFORE THURSDAY, DECEMBER 14TH)
34-TON TOW BEHIND LOG SPLITTER W/KOHLER CH270 7 HP GAS ENGINE (UNUSED, NO REMOVAL BEFORE THURSDAY, DECEMBER 14TH)	1436 TMG INDUSTRIAL TMG-MS2119
1428 TMG INDUSTRIAL TMG-GSG9	19'L X 21'S DOUBLE GARAGE METAL SHED (UNUSED, NO REMOVAL BEFORE THURSDAY, DECEMBER 14TH)
WALK BEHIND STUMP GRINDER W/KOHLER CH440 14 HP GAS ENGINE (UNUSED, NO REMOVAL BEFORE THURSDAY, DECEMBER 14TH)	1437 TMG INDUSTRIAL TMG-M51320A
1429 TMG INDUSTRIAL TMG-GSG9	20'L X 13'W GARAGE METAL SHED (UNUSED, NO REMOVAL BEFORE THURSDAY, DECEMBER 14TH)
WALK BEHIND STUMP GRINDER W/KOHLER CH440 14 HP GAS ENGINE (UNUSED, NO REMOVAL BEFORE THURSDAY, DECEMBER 14TH)	1438 TMG INDUSTRIAL TMG-MS1020A
1430 TMG INDUSTRIAL TMG-GWC6	20'L X 10'W GARAGE METAL SHED ((UNUSED, NO REMOVAL BEFORE THURSDAY, DECEMBER 14TH)
TOW BEHIND 6" CHIPPER W/KOHLER 14 HP GAS ENGINE (UNUSED, NO REMOVAL BEFORE THURSDAY, DECEMBER 14TH)	1439 TMG INDUSTRIAL TMG-GH820
1431 TMG INDUSTRIAL TMG-GWC4	20'L X 8'W TWIN WALL ALUMINUM FRAME GREENHOUSE (UNUSED, NO REMOVAL BEFORE THURSDAY, DECEMBER 14TH)
4" WOOD CHIPPER W/KOHLER 7 HP GAS ENGINE (UNUSED, NO REMOVAL BEFORE THURSDAY, DECEMBER 14TH)	1440 TMG INDUSTRIAL TMG-GH820
1432 TMG INDUSTRIAL TMG-GWC3	20'L X 8'W TWIN WALL ALUMINUM FRAME GREENHOUSE (UNUSED, NO REMOVAL BEFORE THURSDAY, DECEMBER 14TH)
TOW BEHIND 3-IN-1 CHIPPER/SHREDDER VACUUM W/KOHLER CH270 7 HP GAS ENGINE (UNUSED, NO REMOVAL BEFORE THURSDAY, DECEMBER 14TH)	1441 TMG INDUSTRIAL TMG-GH810
1433 TMG INDUSTRIAL TMG-1500PML	10'L X 8'W TWIN WALL ALUMINUM FRAME GREENHOUSE (UNUSED, NO REMOVAL BEFORE THURSDAY, DECEMBER 14TH)
1,500 LB CAP PORTABLE MOTORCYCLE/ATV LIFT (UNUSED, NO REMOVAL BEFORE THURSDAY, DECEMBER 14TH)	1442 TMG INDUSTRIAL TMG-GH810
1434 TMG INDUSTRIAL TMG-SP50	10'L X 8'W TWIN WALL ALUMINUM FRAME GREENHOUSE (UNUSED, NO REMOVAL BEFORE THURSDAY, DECEMBER 14TH)
1,000 LB CAP PORTABLE MOTORCYCLE/ATV LIFT (UNUSED, NO REMOVAL BEFORE THURSDAY, DECEMBER 14TH)	1443 TMG INDUSTRIAL TMG-MS0810
	8'L X 10'W APEX ROOF METAL SHED (UNUSED, NO REMOVAL BEFORE THURSDAY, DECEMBER 14TH)

13% BUYERS PREMIUM ON ALL ITEMS

MARYSVILLE TOOLS & EQUIPMENT - ONLINE ONLY 12/1/2023-12/8/2023

LOT #	LOT #
1444 TMG INDUSTRIAL TMG-MS0810	1453 TMG INDUSTRIAL TMG-MS2500-RD101
8'L X 10'W APEX ROOF METAL SHED (UNUSED, NO REMOVAL BEFORE THURSDAY, DECEMBER 14TH)	GARAGE ROLL-UP DOOR FOR METAL BARN SHEDS (UNUSED, NO REMOVAL BEFORE THURSDAY, DECEMBER 14TH)
1445 TMG INDUSTRIAL TMG-MS0608	1454 LOT, (10) 3/8" X 20' G70 CHAINS & (5) 9,200 LB RATCHET BINDERS (UNUSED, NO REMOVAL BEFORE THURSDAY, DECEMBER 14TH)
6'L X 10'W APEX ROOF METAL SHED (UNUSED, NO REMOVAL BEFORE THURSDAY, DECEMBER 14TH)	
1446 TMG INDUSTRIAL TMG-MS0608	1455 LOT, ASSORTED SIZE SCREW PIN ANCHOR SHACKLES (UNUSED)
6'L X 10'W APEX ROOF METAL SHED (UNUSED, NO REMOVAL BEFORE THURSDAY, DECEMBER 14TH)	
1447 TMG INDUSTRIAL TMG-MGB79	1456 LOT, ASSORTED SIZE SCREW PIN ANCHOR SHACKLES (UNUSED)
79" METAL RAISED GARDEN BED (UNUSED, NO REMOVAL BEFORE THURSDAY, DECEMBER 14TH)	
1448 TMG INDUSTRIAL TMG-MGB79	1457 LOT, ASSORTED RATCHET STRAPS (UNUSED)
79" METAL RAISED GARDEN BED (UNUSED, NO REMOVAL BEFORE THURSDAY, DECEMBER 14TH)	
1449 TMG INDUSTRIAL TMG-MS0408	1700 HYDROTECH
4'L X 8'W BICYCLE/TOOLS METAL PENT SHED (UNUSED, NO REMOVAL BEFORE THURSDAY, DECEMBER 14TH)	HYDRAULIC PUMP W/WORLDWIDE WWE20-18-256TC 20 HP ELECTRIC MOTOR, 230/460V, 3 PHASE
1450 TMG INDUSTRIAL TMG-MS0408	1701 HYDROTECH
4'L X 8'W BICYCLE/TOOLS METAL PENT SHED (UNUSED, NO REMOVAL BEFORE THURSDAY, DECEMBER 14TH)	HYDRAULIC PUMP W/WORLDWIDE WWE20-18-256TC 20 HP ELECTRIC MOTOR, 230/460V, 3 PHASE
1451 TMG INDUSTRIAL TMG-MS2500-RD101	1702 KOOLANT KOOLERS HCV3000PR-L-M
GARAGE ROLL-UP DOOR FOR METAL BARN SHEDS (UNUSED, NO REMOVAL BEFORE THURSDAY, DECEMBER 14TH)	COOLANT CHILLER, 380/460V, 3 PHASE
1452 TMG INDUSTRIAL TMG-RD100	1703 KOOLANT KOOLERS HCV3000PR-L-M
AUTOMATIC GARAGE ROLL-UP DOOR W/REMOTE CONTROL (UNUSED, NO REMOVAL BEFORE THURSDAY, DECEMBER 14TH)	COOLANT CHILLER, 380/460V, 3 PHASE
	1704 120-GAL AIR COMPRESSOR W/BALDOR M2535T 30 HP ELECTRIC MOTOR, 230/460V, 3 PHASE

MARYSVILLE TOOLS & EQUIPMENT - ONLINE ONLY 12/1/2023-12/8/2023

LOT #	LOT #
1705 GNB SCR100-24-1050T1-U 48V BATTERY CHARGER, 480V, 3 PHASE	1716 LOT, DAP SMARTBOND ADHESIVE CANS ON THIS PALLET
1706 SQUARE D EE15T151HCT 3 PHASE TRANSFORMER, 240/480V, 3 PHASE	1717 LOT, TARCO FIBERGLASS MINERAL SURFACED BLACK ROLL ROOFING ROLLS ON THIS PALLET
1707 CUMMINS/ONAN 80DGDA 80 KW GEN SET W/CUMMINS 5.9L 6 CYL DIESEL ENGINE	1718 LOT, DAP SMARTBOND ADHESIVE CANS & ASSORTED FASTENERS ON THIS PALLET
1708 CUMMINS/ONAN GGDB-3380136 20 KW STANDBY GENERATOR W/FORD 4 CYL NATURAL GAS ENGINE & TRANSFER SWITCH, HOUR METER READS: 20	1719 LOT, ASSORTED FASTENERS ON THIS PALLET
1709 MILLER BOBCAT 225 CC/CV WELDER, 8,500W GENERATOR, HOUR METER READS: 1,035	1720 LOT, JUMBO TEX 40" X 500 SQ FT WEATHER RESISTIVE BARRIER ROLLS ON THIS PALLET
1710 JOHN DEERE X304 RIDING LAWN MOWER (MISSING BATTERY, HOOD CRACKED, NEEDS REPAIRS)	1721 LOT, JUMBO TEX 40" X 500 SQ FT WEATHER RESISTIVE BARRIER ROLLS ON THIS PALLET
1711 33"L X 61"W X 38"H OIL STORAGE TANK W/BALCRANK BOBCAT 300, 450 PSI PNEUMATIC PUMP, HOSE & HOSE REEL (PREVIOUSLY HELD OIL)	1722 LOT, JOHNS MANVILLE 133.68 SQ FT R19 INSULATION BATTS ON THIS PALLET
1712 KUBOTA LA3405 LOADER ATTACHMENT	1723 LOT, JOHNS MANVILLE 106.56 SQ FT R13 UNFACED INSULATION BATTS ON THIS PALLET
1713 LOT, ASSORTED FASTENERS & ADHESIVES ON THESE (2) PALLETS	1724 LOT, JOHNS MANVILLE 40 SQ FT R13 INSULATION BATTS ON THIS PALLET
1715 LOT, ZIP SYSTEMS COMPONENTS ON THIS PALLET	1725 LOT, JOHNS MANVILLE R30 INSULATION BATTS ON THIS PALLET
	1726 LOT, JOHNS MANVILLE 133.68 SQ FT R19 INSULATION BATTS ON THIS PALLET

MARYSVILLE TOOLS & EQUIPMENT - ONLINE ONLY 12/1/2023-12/8/2023

LOT #	LOT #
1727 LOT, JOHNS MANVILLE 106.56 SQ FT R13 INSULATION BATTS ON THIS PALLET	1737 GENERAL 330 2-PERSON POWER HOLE DIGGER W/HONDA GXV160 GAS ENGINE (NO AUGERS)
1728 LOT, JOHNS MANVILLE 106.56 SQ FT R13 UNFACED INSULATION BATTS ON THIS PALLET	1738 JET SKI/SNOWMOBILE DOLLY
1729 LOT, JOHNS MANVILLE 106.56 SQ FT R13 UNFACED INSULATION BATTS ON THIS PALLET	1739 BRINLY BST-350 TOW BEHIND BROADCAST SPREADER
1730 LOT, JOHNS MANVILLE 88 SQ FT R30 INSULATION BATTS ON THIS PALLET	1740 LOT, ASSORTED PVD PIPE SECTIONS
1731 LOT, (1) CHEV SILVERADO TAILGATE & (1) REAR BUMPER (FITS 2023 CHEV SILVERADO 2500, UNUSED)	1741 LOT, ASSORTED AUTOMOTIVE EQUIPMENT ON THIS PALLET
1732 BRUTE 49"L X 40"W X 12"H DIAMOND PLATE BED SAFE STORAGE BOX (NO KEY)	1742 LOT, ASSORTED HOSE & AUTOMOTIVE EQUIPMENT ON THIS PALLET
1733 BRUTE 49"L X 40"W X 12"H DIAMOND PLATE BED SAFE STORAGE BOX (NO KEY)	1743 THULE ATLANTIS 1800 CARGO BOX W/KEY
1734 GLASS DOOR FOR KUBOTA SKID STEER (UNUSED)	1744 THULE ATLANTIS 1800 CARGO BOX (NO KEY)
1735 LOT, (5) ASSORTED KUBOTA ENGINE COVERS (DAMAGED, NEEDS REPAIRS)	1745 LOT, (4) 24" WHEELS ON THIS PALLET
1736 LOT, (2) GAS POWERED PRESSURE WASHERS, (1) GAS CHAINSAW & (1) ELECTRIC AIR COMPRESSOR ON THIS PALLET (NEEDS REPAIR)	1746 LOT, (4) 14-1/2" EQUIPMENT WHEELS ON THIS PALLET
	1747 LOT, (3) MICHELIN XDA5 11R24.5 UNMOUNTED TIRES ON THIS PALLET
	1748 LOT, (2) MAXXIS BIGHORN 2.0 26X11.00R12 & (2) 26X9.00R12 MOUNTED TIRES ON THIS PALLET

MARYSVILLE TOOLS & EQUIPMENT - ONLINE ONLY 12/1/2023-12/8/2023

LOT #	LOT #
1749 LOT, (4) 18"L X 48"W X 18"H TRUCK STORAGE BOXES ON THIS PALLET	1761 LOT, PUMP W/TECO WESTINGHOUSE MAX-E1 20 HP/15KW HAZARDOUS LOCATION INVERTER DUTY MOTOR, 230/460V, 3 PHASE & ASSORTED CONTRACTORS SUPPLIES ON THIS PALLET
1750 LOT, (1) 18" X 48" X 18" & (2) 18" X 36" X 18" BOLT-ON TOOL STORAGE CABINETS ON THIS PALLET	1762 MODERN EQUIPMENT CO 1YD/2,000 LB CAP SELF-DUMPING HOPPER W/FORK POCKETS ON CASTERS
1751 LOT, (4) 18" X 48" X 18" BOLT-ON TOOL STORAGE CABINETS ON THIS PALLET	1763 LOT, (1) ACETYLENE & (1) OXYGEN GAS CYLINDERS & ASSORTED CONTRACTORS TOOLS IN THIS BIN (MUST TAKE BIN)
1752 LOT, (6) 18" X 48" X 18" BOLT-ON TOOL STORAGE CABINETS ON THIS PALLET	1764 LOT, ASSORTED CONTRACTORS SUPPLIES IN THIS BIN (MUST TAKE BIN)
1753 1988 IETZ RS-15-K3403-6 SS BLENDER, 230/460V	1765 LOT, (4) WESTWARD 4' A-FRAME LADDERS ON THIS PALLET
1754 SS SPRAY CONVEYOR PAN WASHER, 230/460V, 3 PHASE	1766 LOT, CINDER BLOCKS ON THESE (2) PALLETS
1755 SS DOUBLE AUGER MEAT STUFFER & COMPONENTS, 230/460V, 3 PHASE	1767 LOT, ASSORTED CINDER BLOCKS & PAVERS ON THESE (3) PALLETS (SOME ARE DAMAGED)
1756 LOT, CAPTIVEAIRE 54" X 90" X 24" EXHAUST HOOD & PIPES	1768 12" X 8" X 6" CYPRESS STR SIDE RUSTIC STACK STONES (APPROX 72/PCS)
1757 SS CONVEYOR TABLE	1769 KUBOTA D1803-CR-T-EW04 1.8L, 3 CYL DIESEL ENGINE ON ENGINE STAND W/FORK POCKETS (CONDITION UNKNOWN)
1758 LOT, ASSORTED SS CAGES & STANDS ON THIS PALLET	1770 CUMMINS ONAN 7HGJAD-2139J 7 KW GASOLINE GENERATOR, 120V, SINGLE PHASE
1759 LOT, (1) SEA PRO SYSTEMS ET-900S2 & (1) PROMENS 5646 PACKAGE SEALING MACHINES/COMPONENTS IN THIS BIN (MUST TAKE BIN)	1771 BETTER BUILT 100-GAL L-SHAPE TRANSFER TANK
1760 2022 RHEEM G100-200 97-GAL LP GAS COMMERCIAL HOT WATER HEATER	

13% BUYERS PREMIUM ON ALL ITEMS

MARYSVILLE TOOLS & EQUIPMENT - ONLINE ONLY 12/1/2023-12/8/2023

LOT #	LOT #
1772 LOT, ASSORTED ELECTRICAL COMPONENTS TO INCLUDE: 480W WATER TIGHT PLUGS & 100 AMP BREAKERS IN THIS BIN (MUST TAKE BIN)	1781 LOT, ASSORTED CONTRACTORS SUPPLIES TO INCLUDE: (2) VNE PN181SR ACTUATORS & VARIOUS VALVES & PIPE WELD MOUNTS IN THIS BIN (MUST TAKE BIN)
1773 LOT, ASSORTED ELECTRICAL CONTRACTORS SUPPLIES IN THIS BIN (MUST TAKE BIN)	1782 LOT, ASSORTED ELECTRICAL CONTRACTORS SUPPLIES TO INCLUDE: LIGHT SWITCHES, FIXTURES & CORE GRIPS IN THIS BIN (MUST TAKE BIN)
1774 LOT, ASSORTED SS PIPE ELBOWS IN THIS BIN (MUST TAKE BIN)	1783 LOT, ASSORTED ELCTRICAL CABLE IN THIS BIN (MUST TAKE BIN)
1775 LOT, ASSORTED ELECTRICAL WIRE & CABLE IN THIS BIN (MUST TAKE BIN)	1784 LOT, ASSORTED CONTRACTORS SUPPLIES IN THIS BIN (MUST TAKE BIN)
1776 LOT, ASSORTED CONTRACTORS SUPPLIES TO INCLUDE: VARIOUS HOSE CLAMPS & ELECTRICAL SWITCHES IN THIS BIN (MUST TAKE BIN)	1785 LOT, ASSORTED CONTRACTORS SUPPLIES IN THIS BIN (MUST TAKE BIN)
1777 LOT, ASSORTED ELECTRICAL CONTRACTORS SUPPLIES TO INCLUDE: JUNCTION BOXES, BALLASTS & BREAKERS IN THIS BIN (MUST TAKE BIN)	1786 LOT, ASSORTED ELECTRICAL CABLE IN THIS BIN (MUST TAKE BIN)
1778 LOT, ASORTED ELECTRICAL CONTRACTORS SUPPLIES TO INCLUDE: JUNCTION BOXES, LIGHT FIXTURES, PRESSURE SWITCHES & BREAKERS (MUST TAKE BIN)	1787 LOT, ASSORTED BEVELED STEEL PIPE SECTIONS IN THIS BIN (MUST TAKE BIN)
1779 LOT, ASSORTED ELCECTRICAL BREAKER BOXES & SOFT STARTS IN THIS BIN (MUST TAKE BIN)	1788 LOT, ASSORTED FLEXIBLE & WATER TIGHT CONDUIT IN THIS BIN (MUST TAKE BIN)
1780 LOT, ASSORTED CONTRACTORS SUPPLIES TO INCLUDE: EMERGENCY RESPIRATOR HOUSINGS, COMO FILTRATION SYSTEM COMPONENTS & HP TONERS IN THIS BIN (MUST TAKE BIN)	1789 LOT, ASSORTED ELECTRICAL CONTRACTORS SUPPLIES TO INCLUDE: LIGHT COVERS, FIXTURES & BREAKER BOXES IN THIS BIN (MUST TAKE BIN)
	1791 LOT, ASSORTED COMPUTER PARTS & CONTROL MODULES IN THIS BIN (MUST TAKE BIN)

MARYSVILLE TOOLS & EQUIPMENT - ONLINE ONLY 12/1/2023-12/8/2023

LOT #	LOT #
1792 LOT, ASSORTED ELECTRICAL CABLES IN THIS BIN (MUST TAKE BIN)	1804 BEIER VARIATOR 20BK WORM DRIVE MOTOR
1793 LOT, ASSORTED CONTRACTORS SUPPLIES TO INCLUDE: VIEGA 88085 4" X 4" PIPE ELBOWS & VARIOUS SIZE HEX BOLTS IN THIS BIN (MUST TAKE BIN)	1805 BEIER VARIATOR 20BK WORM DRIVE MOTOR
1794 LOT, ASSORTED CONTRACTORS SUPPLIES TO INCLUDE: GRINDING WHEELS & BRASS PIPE FITTINGS ON THIS PALLET	1806 TOSHIBA/HOUSTON B3004FLF4BM 300 HP, 4 POLES, TIKK TYPE 3 PHASE INDUCTION MOTOR, 460V
1795 LOT, ASSORTED ELECTRICAL CABLE ON THIS PALLET	1807 10'L X 8'W TRENCH SHORING BOX W/SPREADERS
1796 LOT, ASSORTED ELECTRICAL CONTRACTORS SUPPLIES	1808 10'L X 8'W TRENCH SHORING BOX W/SPREADERS
1797 LOT, HEAT EXCHANGER COMPONENTS ON THIS PALLET	1809 10'L X 6'W TRENCH SHORING W/SPREADERS
1798 LOT, (17) ASSORTED PNEUMATIC CYLINDERS 7 (1) STEEL FRAME ON THIS PALLET	1810 10'L X 6'W TRENCH SHORING W/SPREADERS
1799 LOT, (2) HYDRAULIC CYLINDERS ON THIS PALLET	1811 6'L X 6'W TRENCH SHORING BOX W/SPREADERS
1800 LOT, (1) 3" BACKFLOW PREVENTER & (1) 4" BRONE SIMPLEX STRAINER ON THIS PALLET	1812 6'L X 6'W TRENCH SHORING BOX W/SPREADERS
1801 ROVALVE L20-AMSS 16" KNIFE VALVE	1813 10'L X 4'W TRENCH SHORING BOX W/SPREADERS
1802 AIR COMPRESSOR MOTOR ON THIS PALLET	1814 TOWMOTOR LT35 2,000 LB CAP PROPANE FORKLIFT W/KEY
1803 METAL CONVEYOR BELT	2001 2015 HAAS VF-3YT CNC VERTICAL MILLING MACHINE, 25" X 54" T-SLOT TABLE, 20-STATION AUTOMATIC TOOL CHANGER, HAAS DIGITAL CONTROLS, HAAS PENDANT CONTROL, RENSHAW INSPECTION PROBE, 190-260V, 3 PHASE SERIAL NUMBER: 1124918

MARYSVILLE TOOLS & EQUIPMENT - ONLINE ONLY 12/1/2023-12/8/2023

LOT #**2002 HAAS SET-TRUE 3565**

10" 4TH AXIS INDEXER, 10" 3-JAW CHUCK

2003 HAAS

TOOL CART W/ASSORTED CAT 40 TOOLING

2004 HARDINGE CHNC

BAR & CHUCKING MACHINE/LATHE, 30" DOVETAIL
BED, 4" SWING, 1-3/16" THRU-SPINDLE, OILER, 230V,
3 PHASE
SERIAL NUMBER: CNC-453

2005 SOUTH BEND CLK117RX

16" SWING BENCH TYPE ENGINE LATHE, 36" BED,
3-JAW CHUCK, THRU-SPINDLE, TOOL POST HOLDER,
TOOL STOP, 250V
SERIAL NUMBER: 12870HKX15

2006 SOUTH BEND CLK117RX

16" SWING BENCH TYPE ENGINE LATHE, 36" BED,
3-JAW CHUCK, THRU-SPINDLE, TOOL POST HOLDER,
TOOL STOP, 250V
SERIAL NUMBER: 12884HKX15

2007 DELTA ROCKWELL

11" SWING METAL CUTTING LATHE, 51" BED, 3-JAW
CHUCK, THRU-SPINDLE, TOOL POST HOLDER, TOOL
STOP, 115/230V, SINGLE PHASE
SERIAL NUMBER: 1383434

2008 R.K. LE BLONDE MACHINE TOOL CO.

20" SWING ENGINE LATHE, 78" BED, 3-JAW CHUCK,
THRU-SPINDLE, TOOL POST HOLDER, TOOL STOP,
STEADY REST, 220/440V, SINGLE PHASE
SERIAL NUMBER: 6E966

2009 SISTIG MACHINERY CO

1.5 HP VERTICAL MILL, 9" X 42" POWER FEED
TABLE, 6" MACHINIST VISE W/ASSORTED TOOLING
& COLLETS
SERIAL NUMBER: 3050

LOT #**2010 LOT, MILWAUKEE H HORIZONTAL MILL, 10"****X**

50" FEED

TABLE, 6.5" 3-JAW INDEX, THRU-SPINDLE, 6"

MACHINIST VISE & ASSORTED TOOLING

SERIAL NUMBER: 18-4996

2011 CINCINNATI MILLING MACHINE CO

TOOL GRINDER, 440V, 3 PHASE

SERIAL NUMBER: 31521C5U-23

2012 CINCINNATI

TOOL GRINDER, W/5.5" X 36" FEED TABLE

SERIAL NUMBER: 1D2T1J-520

2013 SHOP BUILT VERTICAL DRILL**W/PNEUMATIC**

HOLD DOWNS,

115/208-230V, SINGLE PHASE

2014 C.R. ONSRUD INC 24210-S

7.5 HP INVERTED ROUTER, 220V

SERIAL NUMBER: 24410

2015 ROPER WHITNEY CO PEXTO 3617-D

18-GAUGE CAP POWERED COMBINATION ROTARY

MACHINE W/FOOT CONTROL, 230V, 3 PHASE

SERIAL NUMBER: T42-4-94

2016 BAILEIGH PH-24A

PNEUMATIC PLANISHING HAMMER W/FOOT

CONTROL

SERIAL NUMBER: 16052024

2017 LOT, 24" X 48" X 6-1/2" PRECISION GRANITE

MACHINIST TABLE W/(2) ROLLER STANDS

2018 JET HBS-814GH

1 HP GEARED HEAD HORIZONTAL BANDSAW

W/BLADES, 115V, SINGLE PHASE

MARYSVILLE TOOLS & EQUIPMENT - ONLINE ONLY 12/1/2023-12/8/2023

LOT #	LOT #
2019 KALAMAZOO H9AW HORIZONTAL BANDSAW W/BLADES, 115-208/230V	2029 JET JBG-8A 1 HP, 8" SHOP PEDESTAL GRINDER W/STAND, 115V
2020 WELLSAW 850 1 HP HORIZONTAL BANDSAW, 115/230V, SINGLE PHASE	2030 CENTRAL MACHINERY 60603 20-TON MANUAL HYDRAULIC SHOP PRESS
2021 DELTA ROCKWELL 28-365 16" VERTICAL BANDSAW	2031 ONAN 12.5JCL 12.5 KW STANDBY GENERATOR W/4 CYL LP GAS ENGINE, 120, 208-240V, SINGLE/3 PHASE
2022 GROB INC 4V-18 18" VERTICAL METAL CUTTING BANDSAW, 230V	2032 LINCOLN ELECTRIC IDEALARC R3R-400 STICK WELDING POWER SOURCE, 230/460V, 3 PHASE
2023 ROPER WHITNEY CO PEXTO 416 40", 16-GAUGE MANUAL SLIP ROLLER SHEET METAL BENDER	2033 LINCOLN ELECTRIC IDEALARC R3M-400 DC ARC WELDING POWER SOURCE ON CASTERS, 230/460V, 3 PHASE
2024 NATIONAL SHEET METAL MACHINES INC U9616 16-GAUGE 97" HAND BRAKE	2034 MILLER DIALARC 250 AC/DC CONSTANT CURRENT AC/DC ARC WELDING POWER SOURCE ON CASTERS, 200/230/460V, SINGLE PHASE
2025 CLAUSING CORP 2220 1.5 HP VERTICAL MILL W/ROCKWELL C70135 MULTI-DRILL DRILL HEAD ATTACHMENT, 115/208-230V, SINGLE PHASE	2035 HYPER THERM POWERMAX 1000 G3 PORTABLE PLASMA CUTTING SYSTEM W/CART & CONSUMABLES, 208-480V, SINGLE OR 200-480V 3 PHASE
2026 ROCKWELL 15-081 .5 HP DRILL PRESS W/MULTI-DRILL BIT ATTACHMENT, 115V, SINGLE PHASE	2036 PULLMAN ERMATOR S36 PORTABLE HEPA DUST EXTRACTOR, 230V (NO HOSE OR ATTACHMENTS)
2027 JET J-2550 1 HP 20" FLOOR DRILL PRESS, 115/230V, SINGLE PHASE	2037 PULLMAN ERMATOR C3000 PORTABLE DUST EXTRACTOR W/HOSES & ATTACHMENTS
2028 QUEEN CITY MACHINE TOOL CO 2 HP PEDESTAL GRINDER W/STAND, 230/460V	2038 INGERSOLL RAND UP6-STAS-125 W/DR 125 PSI 80-GAL AIR COMPRESSOR W/DRIER, 208V, 3 PHASE SERIAL NUMBER: UP5611U07082

13% BUYERS PREMIUM ON ALL ITEMS

MARYSVILLE TOOLS & EQUIPMENT - ONLINE ONLY 12/1/2023-12/8/2023

LOT #	LOT #
2038 BINGERSOLL RAND T30	2048 TMG INDUSTRIAL TMG-TC28
80-GAL VERTICAL AIR COMPRESSOR W/7.5 HP BELT DRIVEN ELECTRIC MOTOR, 230V, SINGLE PHASE	TILT BACK TIRE CHANGER W/BEAD BLASTER SYSTEM (UNUSED)
2039 WORTHINGTON	2049 TMG INDUSTRIAL TMG-TC24
60-GAL VERTICAL AIR COMPRESSOR W/5 HP BELT DRIVEN ELECTRIC MOTOR, 230/460V, 3 PHASE	24" SEMI AUTOMATIC TIRE CHANGER (UNUSED)
2040 TMG INDUSTRIAL TMG-ACE80	2050 TMG INDUSTRIAL TMG-TC24
7.5 HP, 175 PSI, 80-GAL VERTICAL AIR COMPRESSOR, 230V, SINGLE PHASE (UNUSED) SERIAL NUMBER: HS003230908	24" SEMI AUTOMATIC TIRE CHANGER (UNUSED)
2041 TMG INDUSTRIAL TMG-GAC40	2051 TMG INDUSTRIAL TMG-ALS61
175 PSI 40-GAL 2-STAGE AIR COMPRESSOR W/LONCIN G300FA GAS ENGINE (UNUSED)	6,000 LB PORTABLE MID RISE SCISSOR LIFT (UNUSED)
2042 TMG INDUSTRIAL TMG-HW41R	2052 H & G 250H
4,000 PSI DIESEL FIRED HOT WATER PRESSURE WASHER W/14 HP KOHLER GAS ENGINE(UNUSED)	PNEUMATIC ADHESIVE DISPENSER
2043 TMG INDUSTRIAL TMG-HW41R	2053 CLARK 1MX20
4,000 PSI DIESEL FIRED HOT WATER PRESSURE WASHER W/14 HP KOHLER GAS ENGINE(UNUSED)	3,700 LB HRT 3-WHEEL FORKLIFT, SIDESHIFT, 36V (NO CHARGER, ACCIDENT DAMAGE)
2044 TMG INDUSTRIAL TMG-WB24	2054 WP 2300 SERIES 4500
24" WHEEL BALANCER, 115V (UNUSED)	ELECTRIC PALLET JACK, 24V (NO POWER CORD)
2045 TMG INDUSTRIAL TMG-WB24	2055 GENIE SLC18
24" WHEEL BALANCER, 115V (UNUSED)	PLATFORM LIFT ON CASTERS
2046 TMG INDUSTRIAL TMG-SP100	2057 COOL JET SYSTEMS 4950
100-TON HYDRAULIC SHOP PRESS (UNUSED)	HIGH PRESSURE COOLANT SYSTEM FOR MORI SEIKI CNC MACHINE TOOLS W/AC 24-FP-230 CHILLER, 190/208-230V, 3 PHASE
2047 TMG INDUSTRIAL TMG-TTC26	2058 LOT, ASSORTED MACHINE TOOLING
26" HEAVY DUTY TRUCK TIRE CHANGER, 220V, SINGLE PHASE (UNUSED)	2059 LOT, (2) VAL 6 INFRARED OIL HEATERS
	2060 E11EVEN E-M1-1X10-S
	ELECTRIC BICYCLE (UNUSED, SILVER, SMALL)

13% BUYERS PREMIUM ON ALL ITEMS

MARYSVILLE TOOLS & EQUIPMENT - ONLINE ONLY 12/1/2023-12/8/2023

<u>LOT #</u>	<u>LOT #</u>
2061 E11EVEN E-M1-1X10-S ELECTRIC BICYCLE (UNUSED, SILVER, SMALL)	2073 E11EVEN E-M1X10-M ELECTRIC BICYCLE (UNUSED, SILVER, MEDIUM)
2062 E11EVEN E-M1-1X10-S ELECTRIC BICYCLE (UNUSED, SILVER, SMALL)	2074 E11EVEN E-M1X10-M ELECTRIC BICYCLE (UNUSED, SILVER, MEDIUM)
2063 E11EVEN E-M1-1X10-S ELECTRIC BICYCLE (UNUSED, SILVER, SMALL)	2075 E11EVEN E-M1X10-M ELECTRIC BICYCLE (UNUSED, SILVER, MEDIUM)
2064 E11EVEN E-M1-1X10-S ELECTRIC BICYCLE (UNUSED, SILVER, SMALL)	2076 E11EVEN E-M1X10-M ELECTRIC BICYCLE (UNUSED, SILVER, MEDIUM)
2065 E11EVEN E-M1-1X10-S ELECTRIC BICYCLE (UNUSED, SILVER, SMALL)	2077 E11EVEN E-M1X10-M ELECTRIC BICYCLE (UNUSED, SILVER, MEDIUM)
2066 E11EVEN E-M1-1X10-S ELECTRIC BICYCLE (UNUSED, SILVER, SMALL)	2078 E11EVEN E-M1X10-M ELECTRIC BICYCLE (UNUSED, SILVER, MEDIUM)
2067 E11EVEN E-M1-1X10-S ELECTRIC BICYCLE (UNUSED, SILVER, SMALL)	2079 E11EVEN E-M1X10-M ELECTRIC BICYCLE (UNUSED, SILVER, MEDIUM)
2068 E11EVEN E-M1-1X10-S ELECTRIC BICYCLE (UNUSED, SILVER, SMALL)	2080 E11EVEN E-FITNESS ELECTRIC BICYCLE (UNUSED, GLOSS BLACK, LARGE)
2069 E11EVEN E-M1-1X10-S ELECTRIC BICYCLE (UNUSED, SILVER, SMALL)	2081 E11EVEN E-FITNESS ELECTRIC BICYCLE (UNUSED, GLOSS BLACK, LARGE)
2070 E11EVEN E-M1X10-M ELECTRIC BICYCLE (UNUSED, SILVER, MEDIUM)	2082 E11EVEN E-FITNESS ELECTRIC BICYCLE (UNUSED, GLOSS BLACK, LARGE)
2071 E11EVEN E-M1X10-M ELECTRIC BICYCLE (UNUSED, SILVER, MEDIUM)	2083 E11EVEN E-FITNESS ELECTRIC BICYCLE (UNUSED, GLOSS BLACK, LARGE)
2072 E11EVEN E-M1X10-M ELECTRIC BICYCLE (UNUSED, SILVER, MEDIUM)	

13% BUYERS PREMIUM ON ALL ITEMS

MARYSVILLE TOOLS & EQUIPMENT - ONLINE ONLY 12/1/2023-12/8/2023

LOT #	LOT #
2084 E11EVEN E-FITNESS	2094 E11EVEN M1X10-M
ELECTRIC BICYCLE (UNUSED, GLOSS BLACK, LARGE)	BICYCLE (UNUSED, SG BLACK, MEDIUM)
2085 E11EVEN E-FITNESS	2095 E11EVEN M1X10-L
ELECTRIC BICYCLE (UNUSED, GLOSS BLACK, MEDIUM)	BICYCLE (UNUSED, SG BLACK, LARGE)
2086 E11EVEN E-FITNESS	2096 E11EVEN FITNESS
ELECTRIC BICYCLE (UNUSED, GLOSS BLACK, MEDIUM)	BICYCLE (UNUSED, GREY, MEDIUM)
2087 E11EVEN E-FITNESS	2097 E11EVEN M1X11-S
ELECTRIC BICYCLE (UNUSED, GLOSS BLACK, MEDIUM)	BICYCLE (UNUSED, SG BLACK, SMALL)
2088 E11EVEN E-FITNESS	2098 E11EVEN M1X11-S
ELECTRIC BICYCLE (UNUSED, GLOSS BLACK, MEDIUM)	BICYCLE (UNUSED, SG BLACK, SMALL)
2089 E11EVEN E-FITNESS	2099 E11EVEN M1X11-S
ELECTRIC BICYCLE (UNUSED, GLOSS BLACK, MEDIUM)	BICYCLE (UNUSED, SG BLACK, SMALL)
2090 E11EVEN M1X10-M	2100 E11EVEN M1X11-S
BICYCLE (UNUSED, SG BLACK, MEDIUM)	BICYCLE (UNUSED, SG BLACK, SMALL)
2091 E11EVEN M1X10-M	2101 E11EVEN M1X11-S
BICYCLE (UNUSED, SG BLACK, MEDIUM)	BICYCLE (UNUSED, SG BLACK, SMALL)
2092 E11EVEN M1X10-M	2102 E11EVEN M1X11-S
BICYCLE (UNUSED, SG BLACK, MEDIUM)	BICYCLE (UNUSED, SG BLACK, SMALL)
2093 E11EVEN M1X10-M	2103 E11EVEN M1X11-S
BICYCLE (UNUSED, SG BLACK, MEDIUM)	BICYCLE (UNUSED, SG BLACK, SMALL)
	2104 E11EVEN M1X11-S
	BICYCLE (UNUSED, SG BLACK, SMALL)
	2105 E11EVEN M1X11-S
	BICYCLE (UNUSED, SG BLACK, SMALL)

MARYSVILLE TOOLS & EQUIPMENT - ONLINE ONLY 12/1/2023-12/8/2023

LOT #	LOT #
2106 E11EVEN MIX11-S	2118 E11EVEN MIX11-L
BICYCLE (UNUSED, SG BLACK, SMALL)	BICYCLE (UNUSED, SG BLACK, LARGE)
2107 E11EVEN MIX11-M	2119 E11EVEN MIX11-L
BICYCLE (UNUSED, SG BLACK, MEDIUM)	BICYCLE (UNUSED, SG BLACK, LARGE)
2108 E11EVEN MIX11-M	2120 E11EVEN MIX11-L
BICYCLE (UNUSED, SG BLACK, MEDIUM)	BICYCLE (UNUSED, SG BLACK, LARGE)
2109 E11EVEN MIX11-M	2121 ORIGAMI
BICYCLE (UNUSED, SG BLACK, MEDIUM)	PADDLER, FOLDING KAYAK/PADDLE BOARD W/SEAT & PADDLE (UNUSED, PINK)
2110 E11EVEN MIX11-M	2122 ORIGAMI
BICYCLE (UNUSED, SG BLACK, MEDIUM)	PADDLER, FOLDING KAYAK/PADDLE BOARD W/SEAT & PADDLE (UNUSED, PINK)
2111 E11EVEN MIX11-M	2123 ORIGAMI
BICYCLE (UNUSED, SG BLACK, MEDIUM)	PADDLER, FOLDING KAYAK/PADDLE BOARD W/SEAT & PADDLE (UNUSED, PINK)
2112 E11EVEN MIX11-M	2124 ORIGAMI
BICYCLE (UNUSED, SG BLACK, MEDIUM)	PADDLER, FOLDING KAYAK/PADDLE BOARD W/SEAT & PADDLE (UNUSED, PINK)
2113 E11EVEN MIX11-M	2125 ORIGAMI
BICYCLE (UNUSED, SG BLACK, MEDIUM)	PADDLER, FOLDING KAYAK/PADDLE BOARD W/SEAT & PADDLE (UNUSED, PINK)
2114 E11EVEN MIX11-M	2126 ORIGAMI
BICYCLE (UNUSED, SG BLACK, MEDIUM)	PADDLER, FOLDING KAYAK/PADDLE BOARD W/SEAT & PADDLE (UNUSED, PINK)
2115 E11EVEN MIX11-M	2127 ORIGAMI
BICYCLE (UNUSED, SG BLACK, MEDIUM)	PADDLER, FOLDING KAYAK/PADDLE BOARD W/SEAT & PADDLE (UNUSED, PINK)
2116 E11EVEN MIX11-L	
BICYCLE (UNUSED, SG BLACK, LARGE)	
2117 E11EVEN MIX11-L	
BICYCLE (UNUSED, SG BLACK, LARGE)	

13% BUYERS PREMIUM ON ALL ITEMS

LOT #

2128 ORIGAMI

PADDLER, FOLDING KAYAK/PADDLE BOARD
W/SEAT & PADDLE (UNUSED, PINK)

2129 ORIGAMI

PADDLER, FOLDING KAYAK/PADDLE BOARD
W/SEAT & PADDLE (UNUSED, PINK)

2130 ORIGAMI

PADDLER, FOLDING KAYAK/PADDLE BOARD
W/SEAT & PADDLE (UNUSED, PINK)

2131 ORIGAMI

PADDLER, FOLDING KAYAK/PADDLE BOARD
W/SEAT & PADDLE (UNUSED, PINK)

2132 ORIGAMI

PADDLER, FOLDING KAYAK/PADDLE BOARD
W/SEAT & PADDLE (UNUSED, PINK)

2133 ORIGAMI

PADDLER, FOLDING KAYAK/PADDLE BOARD
W/SEAT & PADDLE (UNUSED, PINK)

2134 ORIGAMI

PADDLER, FOLDING KAYAK/PADDLE BOARD
W/SEAT & PADDLE (UNUSED, PINK)

2135 ORIGAMI

PADDLER, FOLDING KAYAK/PADDLE BOARD
W/SEAT & PADDLE (UNUSED, PINK)

2136 ORIGAMI

PADDLER, FOLDING KAYAK/PADDLE BOARD
W/SEAT & PADDLE (UNUSED, PINK)

2137 ORIGAMI

PADDLER, FOLDING KAYAK/PADDLE BOARD
W/SEAT & PADDLE (UNUSED, PINK)

LOT #

2138 ORIGAMI

PADDLER, FOLDING KAYAK/PADDLE BOARD
W/SEAT & PADDLE (UNUSED, PINK)

2139 ORIGAMI

PADDLER, FOLDING KAYAK/PADDLE BOARD
W/SEAT & PADDLE (UNUSED, PINK)

2140 ORIGAMI

PADDLER, FOLDING KAYAK/PADDLE BOARD
W/SEAT & PADDLE (UNUSED, PINK)

2141 ORIGAMI

PADDLER, FOLDING KAYAK/PADDLE BOARD
W/SEAT & PADDLE (UNUSED, PINK)

2142 ORIGAMI

PADDLER, FOLDING KAYAK/PADDLE BOARD
W/SEAT & PADDLE (UNUSED, PINK)

2143 ORIGAMI

PADDLER, FOLDING KAYAK/PADDLE BOARD
W/SEAT & PADDLE (UNUSED, PINK)

2144 ORIGAMI

PADDLER, FOLDING KAYAK/PADDLE BOARD
W/SEAT & PADDLE (UNUSED, PINK)

2145 ORIGAMI

PADDLER, FOLDING KAYAK/PADDLE BOARD
W/SEAT & PADDLE (UNUSED, PINK)

2146 ORIGAMI

PADDLER, FOLDING KAYAK/PADDLE BOARD
W/SEAT & PADDLE (UNUSED, PINK)

MARYSVILLE TOOLS & EQUIPMENT - ONLINE ONLY 12/1/2023-12/8/2023

LOT #	LOT #
2147 ORIGAMI	2158 CYBEX
PADDLER, FOLDING KAYAK/PADDLE BOARD W/SEAT & PADDLE (UNUSED, PINK)	ARC TRAINER
2148 ORIGAMI	2160 LOT, HYFO GREEN HF-6000-SX 600W PLANT GROW LIGHTS ON THIS PALLET
PADDLER, FOLDING KAYAK/PADDLE BOARD W/SEAT & PADDLE (UNUSED, PINK)	2161 LOT, HYFO GREEN HF-6000-SX 600W PLANT GROW LIGHTS ON THIS PALLET
2149 ORIGAMI	2162 LOT, HYFO GREEN HF-6000-SX 600W PLANT GROW LIGHTS ON THIS PALLET
PADDLER, FOLDING KAYAK/PADDLE BOARD W/SEAT & PADDLE (UNUSED, PINK)	2163 LOT, HYFO GREEN HF-6000-SX 600W PLANT GROW LIGHTS ON THIS PALLET
2150 ORIGAMI	2164 LOT, HYFO GREEN HF-6000-SX 600W PLANT GROW LIGHTS ON THIS PALLET
PADDLER, FOLDING KAYAK/PADDLE BOARD W/SEAT & PADDLE (UNUSED, PINK)	2165 LOT, HYFO GREEN HF-6000-SX 600W PLANT GROW LIGHTS ON THIS PALLET
2151 LOT, (4) BOXES OF KAYAK PADDLES (UNUSED, 14/PER BOX)	2166 LOT, HYFO GREEN HF-6000-SX 600W PLANT GROW LIGHTS ON THIS PALLET
2152 LOT, (4) BOXES OF KAYAK PADDLES (UNUSED, 14/PER BOX)	2167 LOT, HYFO GREEN HF-6000-SX 600W PLANT GROW LIGHTS ON THIS PALLET
2153 LOT, (4) BOXES OF KAYAK PADDLES (UNUSED, 14/PER BOX)	2168 LOT, ASSORTED MOBILE ANALOG RADIOS & HANDHELD
2154 LOT, (4) BOXES OF KAYAK PADDLES (UNUSED, 14/PER BOX)	RADIO COMPONENTS ON THIS PALLET
2155 LOT, (4) BOXES OF KAYAK PADDLES (UNUSED, 14/PER BOX)	2169 LOT, ASSORTED TRUCK ACCESSORIES ON THIS PALLET
2156 LOT, (4) BOXES OF KAYAK PADDLES (UNUSED, 14/PER BOX)	2170 LOT, ASSORTED TRUCK ACCESSORIES ON THIS PALLET
2157 NAUTILUS COMMERCIAL SERIES T914	
TREADMILL, 115V	

MARYSVILLE TOOLS & EQUIPMENT - ONLINE ONLY 12/1/2023-12/8/2023

LOT #	LOT #
2171 LOT, ASSORTED AUTOMOTIVE PARTS IN THIS BIN (MUST TAKE BIN)	2197 LOT, ASSORTED ALLEN HEAD BOLTS ON THIS PALLET (VARIOUS SIZES)
2172 LOT, ASSORTED AUTOMOTIVE ACCESSORIES ON THIS PALLET	2198 LOT, ASSORTED WOOD SCREWS ON THIS PALLET
2173 LOT, ASSORTED AUTOMOTIVE ACCESSORIES ON THIS PALLET	2199 LOT, ASSORTED ALLEN HEAD BOLTS ON THIS PALLET (VARIOUS SIZES)
2174 LOT, ASSORTED AUTOMOTIVE ACCESSORIES ON THIS PALLET	2200 LOT, ASSORTED GRADE 5 FINE THREAD BOLTS ON THIS PALLET
2175 LOT, ASSORTED AUTOMOTIVE ACCESSORIES ON THIS PALLET	2201 LOT, ASSORTED FASTENERS TO INCLUDE VARIOUS SIZE & HEAD STYLE WOOD SCREWS ON THIS PALLET
2176 LOT, ASSORTED AUTOMOTIVE ACCESSORIES ON THIS PALLET	2202 LOT, ASSORTED FASTENERS TO INCLUDE VARIOUS SIZE & HEAD STYLE WOOD SCREWS ON THIS PALLET
2177 LOT, ASSORTED AUTOMOTIVE ACCESSORIES ON THIS PALLET	2203 LOT, ASSORTED PLASTIC & METAL SIDING ON THIS PALLET
2190 LOT, ASSORTED WINDOWS ON THIS PALLET	2204 LOT, (4) ASSORTED METAL STORAGE CABINETS ON THIS PALLET
2191 LOT, ASSORTED WINDOWS ON THIS PALLET	2210 HOBART 250C11
2192 LOT, ASSORTED DOORS ON THIS PALLET	48V, AUTO STOP/START BATTERY CHARGER, 208/240/480V, 3 PHASE
2193 LOT, ASSORTED DOORS ON THIS PALLET	2211 LOT, 18" MANHOLE SMOKER W/BRIGGS & STRATTON 675 GAS ENGINE
2194 LOT, ASSORTED A307 & GRADE 5 BOLTS ON THIS PALLET	2212 LOT, ASSORTED CONTRACTORS SUPPLIES ON THIS PALLET
2195 LOT, ASSORTED A307 & GRADE 5 BOLTS ON THIS PALLET	
2196 LOT, ASSORTED GRADE 5 FINE THREAD BOLTS ON THIS PALLET	

13% BUYERS PREMIUM ON ALL ITEMS

MARYSVILLE TOOLS & EQUIPMENT - ONLINE ONLY 12/1/2023-12/8/2023

LOT #	LOT #
2213 LOT, ASSORTED CONTRACTORS SUPPLIES ON THIS PALLET	2226 ALUMINUM EXTRUSION MACHINE
-----	-----
2214 LOT, ASSORTED CONTRACTORS SUPPLIES ON THIS PALLET	2227 SILHOUETTE COORDINATE DRIVE TRACING SYSTEM
-----	-----
2215 LOT, ASSORTED CONTRACTORS SUPPLIES ON THIS PALLET	2228 6" MACHINIST VISE (NO HANDLE)
-----	-----
2216 LOT, 2010 INNOVATECH P2400-1PH220 WALK BEHIND CONCRETE FLOOR GRINDER & COMPONENTS, 208/240V, SINGLE PHASE	2229 WILTON 6" BENCH VISE
-----	-----
2217 LOT, ASSORTED CONTRACTORS SUPPLIES ON THIS PALLET	2230 THE CHAS PARKER CO 4" BENCH VISE W/48" X 48" STEEL TABLE
-----	-----
2218 LOT, (1) DOALL DBW-15 RESISTANCE TYPE BUTT WELDER, 240V, SINGLE PHASE & (1) AIRTEK BG-10 AFTER COOLER ON THIS PALLET	2231 LOT, ASSORTED MILWAUKEE TOOLS & SOMFY BLIND MOTORS
-----	-----
2219 LOT, ASSORTED HANDHELD TOOLS ON THIS PALLET	2232 DEWALT DW723 MITER SAW STAND
-----	-----
2220 LOT, ASSORTED BUILDING HARDWARE ON THIS PALLET	2233 CLAUSING TILT ARBOR SAW (NEEDS REPAIR)
-----	-----
2221 LOT, ASSORTED BUILDING HARDWARE ON THIS PALLET	2234 LOT, ASSORTED DRILL BITS
-----	-----
2222 LOT, ASSORTED SCAFFOLDING SYSTEM COMPONENTS IN THIS BIN (MUST TAKE BIN)	2235 LOT, ASSORTED FALL PROTECTION EQUIPMENT
-----	-----
2223 LOT, ASSORTED CONTRACTORS SUPPLIES (MUST TAKE A-FRAME STAND)	2236 DIVERSO SPLICE-O-MATIC TILE CUTTER, 115V
-----	-----
2224 LOT, ASSORTED CONTRACTORS SUPPLIES	2237 LOT, ASSORTED MACHINE TOOLING
-----	-----
	2238 ADVANTAGE MACHINERY COMPANY 8031-0611 DOVETAIL MACHINE, 115/230V, SINGLE PHASE SERIAL NUMBER: 801499/B
-----	-----

MARYSVILLE TOOLS & EQUIPMENT - ONLINE ONLY 12/1/2023-12/8/2023

LOT #	LOT #
2239 CRAFTSMAN 200 MPH/430 CFM GAS YARD BLOWER	2262 LOT, (10) GREAT BEAR 20' 3/8" G70 CHAINS & (5) 9,200 LB RATCHET BINDERS (UNUSED)
2251 LOT, SKLP (5) 9,200 LB RATCHET BINDERS & (5) 20' 3/8" G70 CHAINS (UNUSED)	2263 LOT, (10) GREAT BEAR 20' 3/8" G70 CHAINS & (5) 9,200 LB RATCHET BINDERS (UNUSED)
2252 LOT, ASSORTED SKLP RATCHET STRAPS, (32) 2" X 27' 5T & (16) 1.5" X 27' 3T (UNUSED)	2264 LOT, (10) GREAT BEAR 20' 3/8" G70 CHAINS & (5) 9,200 LB RATCHET BINDERS (UNUSED)
2253 LOT, ASSORTED STIHL POWER TOOLS (PARTS ONLY)	2265 GREAT BEAR 200 ANVIL (UNUSED)
2254 LOT, ASSORTED TIRE CHAINS ON THIS PALLET	2266 GREAT BEAR 200 ANVIL (UNUSED)
2255 LINCOLN RANGER 8 225A GAS WELDER	2267 LOT, ASSORTED FILTERS (FITS CUMMINS N14)
2256 JET HP-15A 15-TON HYDRAULIC PRESS	2268 CHROME TRUCK BUMPER (UNUSED, FITMENT UNKNOWN)
2257 DAYTON 6Y942D 18" METAL/WOOD BANDSAW, 115V	2269 CHROME TRUCK BUMPER (UNUSED, FITMENT UNKNOWN)
2258 HIMMEL 2K16/14 5 HP SAW ARBOR MOTOR, 230/460V, 3 PHASE (NEEDS REPAIR)	2270 ALUMINUM TRUCK BUMPER (FITMENT UNKNOWN)
2259 ECON-O-LINE 1/2 HP DUST COLLECTOR, 115/208-230V, SINGLE PHASE	2271 LOT, (2) TRUCK BOXES
2260 ECON-O-LINE BLAST CABINET	2272 LOT, (2) TRUCK BOXES & (1) QUARTER FENDER
2261 LOT, (10) GREAT BEAR 20' 3/8" G70 CHAINS & (5) 9,200 LB RATCHET BINDERS (UNUSED)	3000 LOT, 2" X 12" KILN DRIED DOUG FIR LUMBER AT VARIOUS LENGTHS FROM APPROX 8' - 20' (NO REMOVAL UNTIL THURSDAY, DECEMBER 14TH)
	3001 LOT, 4" X 12" HEM FIR LUMBER AT APPROX 12', 16' & 20' LENGTHS (NO REMOVAL UNTIL THURSDAY, DECEMBER 14TH)

13% BUYERS PREMIUM ON ALL ITEMS

MARYSVILLE TOOLS & EQUIPMENT - ONLINE ONLY 12/1/2023-12/8/2023

LOT #	LOT #
3002 LOT, 4" X 10" HEM FIR LUMBER AT APPROX 14', 16' & 20' LENGTHS (NO REMOVAL UNTIL THURSDAY, DECEMBER 14TH)	3011 LOT, 2" X 4" CEDAR LUMBER AT APPROX 14' & 16' LENGTHS (NO REMOVAL UNTIL THURSDAY, DECEMBER 14TH)
3003 LOT, 2" X 4" KILN DRIED HEM FIR LUMBER AT APPROX 14', 16', 18' & 20' LENGTHS (NO REMOVAL UNTIL THURSDAY, DECEMBER 14TH)	3012 LOT, 2" X 4" CEDAR LUMBER AT APPROX 14' & 16' LENGTHS (NO REMOVAL UNTIL THURSDAY, DECEMBER 14TH)
3004 LOT, 2" X 6" KILN DRIED DOUG FIR LUMBER AT APPROX 14', 16', 18' & 20' LENGTHS (NO REMOVAL UNTIL THURSDAY, DECEMBER 14TH)	3013 LOT, 4" X 12" KILN DRIED DOUG FIR LUMBER AT APPROX 8' & 12' LENGTHS (NO REMOVAL UNTIL THURSDAY, DECEMBER 14TH)
3005 LOT, 2" X 6" KILN DRIED DOUG FIR LUMBER AT APPROX 16', 18' & 20' LENGTHS (NO REMOVAL UNTIL THURSDAY, DECEMBER 14TH)	3014 LOT, 2" X 4" KILN DRIED HEM FIR LUMBER AT APPROX 8', 10' & 12' LENGTHS (NO REMOVAL UNTIL THURSDAY, DECEMBER 14TH)
3006 LOT, 1" X 6" KILN DRIED DOUG FIR LUMBER AT APPROX 16', 18' & 20' LENGTHS (NO REMOVAL UNTIL THURSDAY, DECEMBER 14TH)	3015 LOT, 2" X 4" KILN DRIED HEM FIR LUMBER AT APPROX 8', 10' & 12' LENGTHS (NO REMOVAL UNTIL THURSDAY, DECEMBER 14TH)
3007 LOT, 1" X 6" KILN DRIED DOUG FIR LUMBER AT APPROX 14', 16', 18' & 20' LENGTHS (NO REMOVAL UNTIL THURSDAY, DECEMBER 14TH)	3016 LOT, 2" X 4" KILN DRIED HEM FIR LUMBER AT APPROX 8', 10' & 12' LENGTHS (NO REMOVAL UNTIL THURSDAY, DECEMBER 14TH)
3008 LOT, 6" X 6", 6" X 8" & 6" X 10" KILN DRIED DOUG FIR LUMBER AT VARIOUS LENGTHS UP TO APPROX 12' (NO REMOVAL UNTIL THURSDAY, DECEMBER 14TH)	3017 LOT, 1" X 12" KILN DRIED DOUG FIR LUMBER AT APPROX 10' LENGTHS (NO REMOVAL UNTIL THURSDAY, DECEMBER 14TH)
3009 LOT, 2" X 4" KILN DRIED HEM FIR LUMBER AT APPROX 12', 14' & 16' LENGTHS (NO REMOVAL UNTIL THURSDAY, DECEMBER 14TH)	3018 LOT, 6" X 6" HEM FIR LUMBER AT APPROX 8' LENGTHS (NO REMOVAL UNTIL THURSDAY, DECEMBER 14TH)
3010 LOT, 3" X 6" DOUG FIR LUMBER AT APPROX 16' LENGTHS (NO REMOVAL UNTIL THURSDAY, DECEMBER 14TH)	3019 LOT, 6" X 6" HEM FIR LUMBER AT APPROX 8' LENGTHS (NO REMOVAL UNTIL THURSDAY, DECEMBER 14TH)
	3020 LOT, 6" X 6" HEM FIR LUMBER AT APPROX 8' LENGTHS (NO REMOVAL UNTIL THURSDAY, DECEMBER 14TH)

MARYSVILLE TOOLS & EQUIPMENT - ONLINE ONLY 12/1/2023-12/8/2023

LOT #	LOT #
3021 LOT, 4" X 8" KILN DRIED DOUG FIR LUMBER AT APPROX 8' LENGTHS (NO REMOVAL UNTIL THURSDAY, DECEMBER 14TH)	3032 LOT, 2" X 4" CEDAR LUMBER AT APPROX 8' LENGTHS (NO REMOVAL UNTIL THURSDAY, DECEMBER 14TH)
3022 LOT, 2" X 6" KILN DRIED HEM FIR LUMBER AT APPROX 6' & 8' LENGTHS (NO REMOVAL UNTIL THURSDAY, DECEMBER 14TH)	3033 LOT, 2" X 4" CEDAR LUMBER AT APPROX 8' LENGTHS (NO REMOVAL UNTIL THURSDAY, DECEMBER 14TH)
3023 LOT, 2" X 4" KILN DRIED HEM FIR LUMBER AT APPROX 6' & 8' LENGTHS (NO REMOVAL UNTIL THURSDAY, DECEMBER 14TH)	3034 LOT, 2" X 4" CEDAR LUMBER AT APPROX 8' LENGTHS (NO REMOVAL UNTIL THURSDAY, DECEMBER 14TH)
3024 LOT, 2" X 4" KILN DRIED HEM FIR LUMBER AT APPROX 8' LENGTHS (NO REMOVAL UNTIL THURSDAY, DECEMBER 14TH)	3035 LOT, 2" X 4" CEDAR LUMBER AT APPROX 8' LENGTHS (NO REMOVAL UNTIL THURSDAY, DECEMBER 14TH)
3025 LOT, 1" X 6" HEM FIR LUMBER AT APPROX 8' LENGTHS (NO REMOVAL UNTIL THURSDAY, DECEMBER 14TH)	3036 10" & 10" CEDAR LUMBER AT VARIOUS LENGTHS UP TO APPROX 2' (NO REMOVAL UNTIL THURSDAY, DECEMBER 14TH)
3026 LOT, 1" X 6" KILN DRIED DOUG FIR LUMBER AT APPROX 8' LENGTHS (NO REMOVAL UNTIL THURSDAY, DECEMBER 14TH)	3037 LOT, 10" X 10" & 12" X 12" CEDAR LUMBER AT VARIOUS LENGTHS UP TO APPROX 2.5' (NO REMOVAL UNTIL THURSDAY, DECEMBER 14TH)
3027 LOT, 1" X 6" DOUG FIR LUMBER AT APPROX 8' LENGTHS (NO REMOVAL UNTIL THURSDAY, DECEMBER 14TH)	3038 LOT, 3/4" X 97" X 44" LAMINATED PARTICLE BOARD (NO REMOVAL UNTIL THURSDAY, DECEMBER 14TH)
3028 LOT, 2" X 4" CEDAR LUMBER AT APPROX 8' LENGTHS (NO REMOVAL UNTIL THURSDAY, DECEMBER 14TH)	3039 LOT, 3/4" X 97" X 44" LAMINATED PARTICLE BOARD (NO REMOVAL UNTIL THURSDAY, DECEMBER 14TH)
3029 LOT, 2" X 4" CEDAR LUMBER AT APPROX 8' LENGTHS (NO REMOVAL UNTIL THURSDAY, DECEMBER 14TH)	3040 LOT, 3/4" X 97" X 44" LAMINATED PARTICLE BOARD (NO REMOVAL UNTIL THURSDAY, DECEMBER 14TH)
3030 LOT, 2" X 4" CEDAR LUMBER AT APPROX 8' LENGTHS (NO REMOVAL UNTIL THURSDAY, DECEMBER 14TH)	3041 LOT, 3/4" X 97" X 44" LAMINATED PARTICLE BOARD (NO REMOVAL UNTIL THURSDAY, DECEMBER 14TH)
3031 LOT, 2" X 4" CEDAR LUMBER AT APPROX 8' LENGTHS (NO REMOVAL UNTIL THURSDAY, DECEMBER 14TH)	3042 LOT, 3/4" X 97" X 44" LAMINATED PARTICLE BOARD (NO REMOVAL UNTIL THURSDAY, DECEMBER 14TH)

13% BUYERS PREMIUM ON ALL ITEMS

MARYSVILLE TOOLS & EQUIPMENT - ONLINE ONLY 12/1/2023-12/8/2023

LOT #	LOT #
3043 LOT, 3/4" X 48" X 96" PLYWOOD BOARDS (NO REMOVAL UNTIL THURSDAY, DECEMBER 14TH)	3052 LOT, TREX ASSORTED COMPOST DECKING AT APPROX 12' LENGTHS (NO REMOVAL UNTIL THURSDAY, DECEMBER 14TH)
3044 LOT, 3/4" X 48" X 96" T & G PLYWOOD SHEATHING (NO REMOVAL UNTIL THURSDAY, DECEMBER 14TH)	3053 LOT, TREX SELECT "MADEIRA BROWN" .82" X 5.5" X 16' & TRANSCEND "GRAVEL PATH" .94" X 5.5" X 16' (NO REMOVAL UNTIL THURSDAY, DECEMBER 14TH)
3045 LOT, 1-1/8" X 48" X 96" T & G PLYWOOD SHEATHING (DAMAGED, NO REMOVAL UNTIL THURSDAY, DECEMBER 14TH)	3054 LOT, TREX SELECT WOODLAND BROWN 2" X 6" X 20' COMPOSITE DECKING (NO REMOVAL UNTIL THURSDAY, DECEMBER 14TH)
3046 LOT, 1-1/8" X 24" X 96" CONCRETE PANEL BOARDS (NO REMOVAL UNTIL THURSDAY, DECEMBER 14TH)	3055 LOT, TREX SELECT "MADEIRA BROWN" .82" X 5.5" X 20' COMPOSITE DECKING (NO REMOVAL UNTIL THURSDAY, DECEMBER 14TH)
3047 LOT, DAKERYN PREMIUM SELECT V4E, 1" X 6" X 10' T & G V-JOINT SIDING (NO REMOVAL UNTIL THURSDAY, DECEMBER 14TH)	3056 LOT, 1/4" X 30" X 48" FIBER CEMENT BOARDS (NO REMOVAL UNTIL THURSDAY, DECEMBER 14TH)
3048 LOT, DAKERYN PREMIUM SELECT V4E, 1" X 6" X 14' T & G V-JOINT SIDING (NO REMOVAL UNTIL THURSDAY, DECEMBER 14TH)	3057 LOT, SAINT-GOBAN M2 TECH 1/2" X 48" X 96" GYPSUM PANELS (NO REMOVAL UNTIL THURSDAY, DECEMBER 14TH)
3049 LOT, DAKERYN PREMIUM SELECT V4E, 1" X 6" X 14' T & G V-JOINT SIDING (NO REMOVAL UNTIL THURSDAY, DECEMBER 14TH)	3058 LOT, 5/16" X 48" X 96" FIBER CEMENT BOARDS (NO REMOVAL UNTIL THURSDAY, DECEMBER 14TH)
3050 LOT, 1-3/8" X 5" SIDING AT VARIOUS LENGTHS FROM APPROX 9' TO 16' (NO REMOVAL UNTIL THURSDAY, DECEMBER 14TH)	3059 LOT, 5/16" X 48" X 96" FIBER CEMENT BOARDS (NO REMOVAL UNTIL THURSDAY, DECEMBER 14TH)
3051 LOT, TREX TRANSCEND FASCIA "SPICED RUM" .70" X 11.375" X 12' COMPOSITE DECKING (NO REMOVAL UNTIL THURSDAY, DECEMBER 14TH)	3060 LOT, DAKERYN PREMIUM SELECT V4E 1" X 6" X 10' T & G V-JOINT SIDING (NO REMOVAL UNTIL THURSDAY, DECEMBER 14TH)

MARYSVILLE TOOLS & EQUIPMENT - ONLINE ONLY 12/1/2023-12/8/2023

LOT #	LOT #
3061 LOT, ASSORTED FIBER CEMENT BOARDS AT VARIOUS LENGTHS FROM APPROX 8' TO 12' (NO REMOVAL UNTIL THURSDAY, DECEMBER 14TH)	3083 2-1/4" X 153" LIVE EDGE CEDAR SLAB (LARGE END 18", SMALL END 9", MEASUREMENTS ARE APPROX, NO REMOVAL UNTIL THURSDAY, DECEMBER 14TH)
3062 LOT, 3/4" X 48" X 96" BUILDING MATERIALS SHEETS (NO REMOVAL UNTIL THURSDAY, DECEMBER 14TH)	3084 3-1/2" X 160" LIVE EDGE CEDAR SLAB (LARGE END 18", SMALL END 17", MEASUREMENTS ARE APPROX, NO REMOVAL UNTIL THURSDAY, DECEMBER 14TH)
3063 LOT, ASSORTED GLULAM LUMBER AT VARIOUS LENGTHS FROM APPROX 9' TO 12' LENGTHS (NO REMOVAL UNTIL THURSDAY, DECEMBER 14TH)	3085 2-1/2" X 151" LIVE EDGE WALNUT SLAB (LARGE END 27", SMALL END 19", MEASUREMENTS ARE APPROX, NO REMOVAL UNTIL THURSDAY, DECEMBER 14TH)
3064 LOT, (15) WEATHER SMART D 9' X 125 LINEAL FOOT ROLLS OF DRAINAGE WRAP (NO REMOVAL UNTIL THURSDAY, DECEMBER 14TH)	3086 2-1/2" X 161" LIVE EDGE WALNUT SLAB (LARGE END 42", SMALL END 36", MEASUREMENTS ARE APPROX, NO REMOVAL UNTIL THURSDAY, DECEMBER 14TH)
3065 LOT, 3" X 24" X 96" FOAM BOARDS (NO REMOVAL UNTIL THURSDAY, DECEMBER 14TH)	3087 3" X 170" LIVE EDGE ELM SLAB (LARGE END 41", SMALL END 21", MEASUREMENTS ARE APPROX, NO REMOVAL UNTIL THURSDAY, DECEMBER 14TH)
3066 LOT, 5/8" X 5-1/2" X 20' PRIMED LUMBER (NO REMOVAL UNTIL THURSDAY, DECEMBER 14TH)	3088 3" X 154" LIVE EDGE WOOD SLAB (LARGE END 39", SMALL END 33", MEASUREMENTS ARE APPROX, NO REMOVAL UNTIL THURSDAY, DECEMBER 14TH)
3067 LOT, GATORBAR 20' COMPOSITE REBAR (NO REMOVAL UNTIL THURSDAY, DECEMBER 14TH)	3089 3" X 154" LIVE EDGE MAPLE SLAB (LARGE END 39", SMALL END 33", MEASUREMENTS ARE APPROX, NO REMOVAL UNTIL THURSDAY, DECEMBER 14TH)
3068 LOT, ASSORTED GLULAM LUMBER AT VARIOUS LENGTHS FROM APPROX 17' TO 25' (NO REMOVAL UNTIL THURSDAY, DECEMBER 14TH)	3090 3" X 195" LIVE EDGE MAPLE SLAB (LARGE END 63", SMALL END 55", MEASUREMENTS ARE APPROX, NO REMOVAL UNTIL THURSDAY, DECEMBER 14TH)
3081 2-1/2" X 130" LIVE EDGE MAPLE SLAB (LARGE END 32", SMALL END 9", MEASUREMENTS ARE APPROX, NO REMOVAL UNTIL THURSDAY, DECEMBER 14TH)	3091 3" X 173" LIVE EDGE MAPLE SLAB (LARGE END 54", SMALL END 33", MEASUREMENTS ARE APPROX, NO REMOVAL UNTIL THURSDAY, DECEMBER 14TH)
3082 1-1/2" X 129" LIVE EDGE CEDAR SLAB (LARGE END 24", SMALL END 16", MEASUREMENTS ARE APPROX, NO REMOVAL UNTIL THURSDAY, DECEMBER 14TH)	3092 3" X 124" LIVE EDGE WALNUT SLAB (LARGE END 29", SMALL END 23", MEASUREMENTS ARE APPROX, NO REMOVAL UNTIL THURSDAY, DECEMBER 14TH)

MARYSVILLE TOOLS & EQUIPMENT - ONLINE ONLY 12/1/2023-12/8/2023

LOT #

3093 3" X 129" LIVE EDGE POPLAR SLAB (LARGE
 END 35",
 SMALL END 24", MEASUREMENTS ARE APPROX, NO
 REMOVAL UNTIL THURSDAY, DECEMBER 14TH)

3094 3-1/2" X 145" LIVE EDGE POPLAR SLAB
 (LARGE END
 27", SMALL END 18", MEASUREMENTS ARE APPROX,
 NO REMOVAL UNTIL THURSDAY, DECEMBER 14TH)

3095 3-1/2" X 129" LIVE EDGE POPLAR SLAB
 (LARGE END
 34", SMALL END 23", MEASUREMENTS ARE APPROX,
 NO REMOVAL UNTIL THURSDAY, DECEMBER 14TH)

3096 3-1/2" X 131" LIVE EDGE POPLAR SLAB
 (LARGE END
 56", SMALL END 41", MEASUREMENTS ARE APPROX,
 NO REMOVAL UNTIL THURSDAY, DECEMBER 14TH)

3097 3-1/2" X 130" LIVE EDGE MAPLE SLAB
 (LARGE END
 57", SMALL END 36", MEASUREMENTS ARE APPROX,
 NO REMOVAL UNTIL THURSDAY, DECEMBER 14TH)

3098 3-1/2" X 129" LIVE EDGE POPLAR SLAB
 (LARGE END
 59", SMALL END 58", MEASUREMENTS ARE APPROX,
 NO REMOVAL UNTIL THURSDAY, DECEMBER 14TH)

3099 2" X 99" LIVE EDGE MAPLE SLAB (LARGE
 END 24",
 SMALL END 19", MEASUREMENTS ARE APPROX, NO
 REMOVAL UNTIL THURSDAY, DECEMBER 14TH)

3100 2-1/4" X 99" LIVE EDGE MAPLE SLAB (LARGE
 END 15",
 SMALL END 14", MEASUREMENTS ARE APPROX, NO
 REMOVAL UNTIL THURSDAY, DECEMBER 14TH)

3101 3-1/2" X 112" LIVE EDGE POPLAR SLAB
 (LARGE END
 15", SMALL END 10", MEASUREMENTS ARE APPROX,
 NO REMOVAL UNTIL THURSDAY, DECEMBER 14TH)

LOT #

3102 3-1/2" X 146" LIVE EDGE POPLAR SLAB
 (LARGE END
 25", SMALL END 23", MEASUREMENTS ARE APPROX,
 NO REMOVAL UNTIL THURSDAY, DECEMBER 14TH)

3103 3-1/2" X 130" LIVE EDGE POPLAR SLAB
 (LARGE END
 32", SMALL END 22", MEASUREMENTS ARE APPROX,
 NO REMOVAL UNTIL THURSDAY, DECEMBER 14TH)

3104 3-1/2" X 146" LIVE EDGE POPLAR SLAB
 (LARGE END
 27", SMALL END 22", MEASUREMENTS ARE APPROX,
 NO REMOVAL UNTIL THURSDAY, DECEMBER 14TH)

3105 3-1/2" X 146" LIVE EDGE POPLAR SLAB
 (LARGE END
 53", SMALL END 47", MEASUREMENTS ARE APPROX,
 NO REMOVAL UNTIL THURSDAY, DECEMBER 14TH)

3106 4" X 144" LIVE EDGE POPLAR SLAB (LARGE
 END 53",
 SMALL END 37", MEASUREMENTS ARE APPROX, NO
 REMOVAL UNTIL THURSDAY, DECEMBER 14TH)

3107 3-1/2" X 143" LIVE EDGE POPLAR SLAB
 (LARGE END
 57", SMALL END 51", MEASUREMENTS ARE APPROX,
 NO REMOVAL UNTIL THURSDAY, DECEMBER 14TH)

3108 3" X 74" LIVE EDGE MAPLE SLAB (LARGE
 END 44",
 SMALL END 21", MEASUREMENTS ARE APPROX, NO
 REMOVAL UNTIL THURSDAY, DECEMBER 14TH)

3109 3" X 74" LIVE EDGE MAPLE SLAB (LARGE
 END 45",
 SMALL END 40", MEASUREMENTS ARE APPROX, NO
 REMOVAL UNTIL THURSDAY, DECEMBER 14TH)

3110 2-1/2" X 103" LIVE EDGE WALNUT SLAB
 (LARGE END
 40", SMALL END 32", MEASUREMENTS ARE APPROX,
 NO REMOVAL UNTIL THURSDAY, DECEMBER 14TH)

3111 2-1/2" X 119" LIVE EDGE MAPLE SLAB
 (LARGE END
 28", SMALL END 25", MEASUREMENTS ARE APPROX,
 NO REMOVAL UNTIL THURSDAY, DECEMBER 14TH)

MARYSVILLE TOOLS & EQUIPMENT - ONLINE ONLY 12/1/2023-12/8/2023

LOT #	LOT #
<p>3112 2-1/2" X 105" LIVE EDGE MAPLE SLAB (LARGE END 32", SMALL END 22", MEASUREMENTS ARE APPROX, NO REMOVAL UNTIL THURSDAY, DECEMBER 14TH)</p>	<p>3121 3" X 89" LIVE EDGE SYCAMORE SLAB (LARGE END 62", SMALL END 43", MEASUREMENTS ARE APPROX, NO REMOVAL UNTIL THURSDAY, DECEMBER 14TH)</p>
<p>3113 2" X 101" LIVE EDGE MAPLE SLAB (LARGE END 34", SMALL END 19", MEASUREMENTS ARE APPROX, NO REMOVAL UNTIL THURSDAY, DECEMBER 14TH)</p>	<p>3122 3" X 86" LIVE EDGE SYCAMORE SLAB (LARGE END 62", SMALL END 39", MEASUREMENTS ARE APPROX, NO REMOVAL UNTIL THURSDAY, DECEMBER 14TH)</p>
<p>3114 3" X 101" LIVE EDGE MAPLE SLAB (LARGE END 42", SMALL END 34", MEASUREMENTS ARE APPROX, NO REMOVAL UNTIL THURSDAY, DECEMBER 14TH)</p>	<p>3123 2-1/2" X 77" LIVE EDGE MAPLE SLAB (LARGE END 22", SMALL END 13", MEASUREMENTS ARE APPROX, NO REMOVAL UNTIL THURSDAY, DECEMBER 14TH)</p>
<p>3115 3" X 115" LIVE EDGE MAPLE SLAB (LARGE END 35", SMALL END 32", MEASUREMENTS ARE APPROX, NO REMOVAL UNTIL THURSDAY, DECEMBER 14TH)</p>	<p>3124 2-1/2" X 68" LIVE EDGE WALNUT SLAB (LARGE END 26", SMALL END 25", MEASUREMENTS ARE APPROX, NO REMOVAL UNTIL THURSDAY, DECEMBER 14TH)</p>
<p>3116 3" X 102" LIVE EDGE MAPLE SLAB (LARGE END 41", SMALL END 35", MEASUREMENTS ARE APPROX, NO REMOVAL UNTIL THURSDAY, DECEMBER 14TH)</p>	<p>3125 2-1/2" X 71" LIVE EDGE ELM SLAB (LARGE END 30", SMALL END 22", MEASUREMENTS ARE APPROX, NO REMOVAL UNTIL THURSDAY, DECEMBER 14TH)</p>
<p>3117 2-1/2" X 55" LIVE EDGE MAPLE SLAB (LARGE END 56", SMALL END 42", MEASUREMENTS ARE APPROX, NO REMOVAL UNTIL THURSDAY, DECEMBER 14TH)</p>	<p>3126 2-1/2" X 64" LIVE EDGE ELM SLAB (LARGE END 25", SMALL END 17", MEASUREMENTS ARE APPROX, NO REMOVAL UNTIL THURSDAY, DECEMBER 14TH)</p>
<p>3118 2-1/2" X 88" LIVE EDGE MAPLE SLAB (LARGE END 27", SMALL END 23", MEASUREMENTS ARE APPROX, NO REMOVAL UNTIL THURSDAY, DECEMBER 14TH)</p>	<p>3127 3" X 76" LIVE EDGE MAPLE SLAB (LARGE END 58", SMALL END 35", MEASUREMENTS ARE APPROX, NO REMOVAL UNTIL THURSDAY, DECEMBER 14TH)</p>
<p>3119 2-1/2" X 81" LIVE EDGE WOOD SLAB (LARGE END 44", SMALL END 28", MEASUREMENTS ARE APPROX, NO REMOVAL UNTIL THURSDAY, DECEMBER 14TH)</p>	<p>3128 3-1/4" X 74" LIVE EDGE MAPLE SLAB (LARGE END 26", SMALL END 32", MEASUREMENTS ARE APPROX, NO REMOVAL UNTIL THURSDAY, DECEMBER 14TH)</p>
<p>3120 3" X 95" LIVE EDGE SYCAMORE SLAB (LARGE END 49", SMALL END 30", MEASUREMENTS ARE APPROX, NO REMOVAL UNTIL THURSDAY, DECEMBER 14TH)</p>	<p>3129 3-1/4" X 74" LIVE EDGE MAPLE SLAB (LARGE END 26", SMALL END 33", MEASUREMENTS ARE APPROX, NO REMOVAL UNTIL THURSDAY, DECEMBER 14TH)</p>

MARYSVILLE TOOLS & EQUIPMENT - ONLINE ONLY 12/1/2023-12/8/2023

LOT #	LOT #
<p>3130 3" X 40" LIVE EDGE MAPLE SLAB (LARGE END 26", SMALL END 18", MEASUREMENTS ARE APPROX, NO REMOVAL UNTIL THURSDAY, DECEMBER 14TH)</p>	<p>3139 3-1/4" X 89" LIVE EDGE WALNUT SLAB (LARGE END 49", SMALL END 35", MEASUREMENTS ARE APPROX, NO REMOVAL UNTIL THURSDAY, DECEMBER 14TH)</p>
<p>3131 2-1/2" X 67" LIVE EDGE CURLY MAPLE SLAB (LARGE END 24", SMALL END 18", MEASUREMENTS ARE APPROX, NO REMOVAL UNTIL THURSDAY, DECEMBER 14TH)</p>	<p>3140 2-1/4" X 93" LIVE EDGE MAPLE SLAB (LARGE END 22", SMALL END 18", MEASUREMENTS ARE APPROX, NO REMOVAL UNTIL THURSDAY, DECEMBER 14TH)</p>
<p>3132 3" X 50" LIVE EDGE CURLY MAPLE SLAB (LARGE END 35", SMALL END 26", MEASUREMENTS ARE APPROX, NO REMOVAL UNTIL THURSDAY, DECEMBER 14TH)</p>	<p>3141 2" X 90" LIVE EDGE WALNUT SLAB (LARGE END 19", SMALL END 15", MEASUREMENTS ARE APPROX, NO REMOVAL UNTIL THURSDAY, DECEMBER 14TH)</p>
<p>3133 2" X 53" LIVE EDGE CURLY MAPLE SLAB (LARGE END 35", SMALL END 26", MEASUREMENTS ARE APPROX, NO REMOVAL UNTIL THURSDAY, DECEMBER 14TH)</p>	<p>3142 2" X 94" LIVE EDGE CURLY MAPLE SLAB (LARGE END 25", SMALL END 20", MEASUREMENTS ARE APPROX, NO REMOVAL UNTIL THURSDAY, DECEMBER 14TH)</p>
<p>3134 2-1/2" X 82" LIVE EDGE CURLY MAPLE SLAB (LARGE END 30", SMALL END 24", MEASUREMENTS ARE APPROX, NO REMOVAL UNTIL THURSDAY, DECEMBER 14TH)</p>	<p>3143 3" X 113" LIVE EDGE CURLY MAPLE SLAB (LARGE END 34", SMALL END 13", MEASUREMENTS ARE APPROX, NO REMOVAL UNTIL THURSDAY, DECEMBER 14TH)</p>
<p>3135 2-1/2" X 102" LIVE EDGE MAPLE SLAB (LARGE END 28", SMALL END 24", MEASUREMENTS ARE APPROX, NO REMOVAL UNTIL THURSDAY, DECEMBER 14TH)</p>	<p>3144 3" X 109" LIVE EDGE CURLY MAPLE SLAB (LARGE END 39", SMALL END 23", MEASUREMENTS ARE APPROX, NO REMOVAL UNTIL THURSDAY, DECEMBER 14TH)</p>
<p>3136 2-1/2" X 107" LIVE EDGE MAPLE SLAB (LARGE END 28", SMALL END 24", MEASUREMENTS ARE APPROX, NO REMOVAL UNTIL THURSDAY, DECEMBER 14TH)</p>	<p>3145 3" X 87" LIVE EDGE ELM SLAB (LARGE END 37", SMALL END 26", MEASUREMENTS ARE APPROX, NO REMOVAL UNTIL THURSDAY, DECEMBER 14TH)</p>
<p>3137 2-1/2" X 107" LIVE EDGE WALNUT SLAB (LARGE END 31", SMALL END 30", MEASUREMENTS ARE APPROX, NO REMOVAL UNTIL THURSDAY, DECEMBER 14TH)</p>	<p>3146 3-1/4" X 86" LIVE EDGE ELM SLAB (LARGE END 48", SMALL END 35", MEASUREMENTS ARE APPROX, NO REMOVAL UNTIL THURSDAY, DECEMBER 14TH)</p>
<p>3138 3-1/2" X 101" LIVE EDGE WALNUT SLAB (LARGE END 32", SMALL END 22", MEASUREMENTS ARE APPROX, NO REMOVAL UNTIL THURSDAY, DECEMBER 14TH)</p>	<p>3147 3-1/4" X 89" LIVE EDGE WOOD SLAB (LARGE END 46", SMALL END 34", MEASUREMENTS ARE APPROX, NO REMOVAL UNTIL THURSDAY, DECEMBER 14TH)</p>
	<p>3148 3-1/4" X 83" LIVE EDGE WOOD SLAB (LARGE END 52", SMALL END 42", MEASUREMENTS ARE APPROX, NO REMOVAL UNTIL THURSDAY, DECEMBER 14TH)</p>

MARYSVILLE TOOLS & EQUIPMENT - ONLINE ONLY 12/1/2023-12/8/2023

LOT #

3149 2-1/4" X 94" LIVE EDGE MAPLE SLAB (LARGE
 END 26",
 SMALL END 21", MEASUREMENTS ARE APPROX, NO
 REMOVAL UNTIL THURSDAY, DECEMBER 14TH)

3150 2-1/4" X 92" LIVE EDGE MAPLE SLAB (LARGE
 END 24",
 SMALL END 20", MEASUREMENTS ARE APPROX, NO
 REMOVAL UNTIL THURSDAY, DECEMBER 14TH)

3151 2-1/4" X 92" LIVE EDGE MAPLE SLAB (LARGE
 END 19",
 SMALL END 14", MEASUREMENTS ARE APPROX, NO
 REMOVAL UNTIL THURSDAY, DECEMBER 14TH)

3152 2-1/4" X 93" LIVE EDGE MAPLE SLAB (LARGE
 END 26",
 SMALL END 25", MEASUREMENTS ARE APPROX, NO
 REMOVAL UNTIL THURSDAY, DECEMBER 14TH)

3153 2-1/4" X 93" LIVE EDGE MAPLE SLAB (LARGE
 END 26",
 SMALL END 24", MEASUREMENTS ARE APPROX, NO
 REMOVAL UNTIL THURSDAY, DECEMBER 14TH)

3154 2-1/4" X 93" LIVE EDGE MAPLE SLAB (LARGE
 END 25",
 SMALL END 24", MEASUREMENTS ARE APPROX, NO
 REMOVAL UNTIL THURSDAY, DECEMBER 14TH)

3155 2-1/2" X 107" LIVE EDGE MAPLE SLAB
 (LARGE END
 40", SMALL END 23", MEASUREMENTS ARE APPROX,
 NO REMOVAL UNTIL THURSDAY, DECEMBER 14TH)

3156 2-1/2" X 106" LIVE EDGE MAPLE SLAB
 (LARGE END
 43", SMALL END 31", MEASUREMENTS ARE APPROX,
 NO REMOVAL UNTIL THURSDAY, DECEMBER 14TH)

3157 2-1/2" X 106" LIVE EDGE MAPLE SLAB
 (LARGE END
 46", SMALL END 35", MEASUREMENTS ARE APPROX,
 NO REMOVAL UNTIL THURSDAY, DECEMBER 14TH)

LOT #

3158 2" X 87" LIVE EDGE SYCAMORE SLAB
 (LARGE
 END 15",
 SMALL END 12", MEASUREMENTS ARE APPROX, NO
 REMOVAL UNTIL THURSDAY, DECEMBER 14TH)

3159 2" X 88" LIVE EDGE SYCAMORE SLAB
 (LARGE
 END 15",
 SMALL END 12", MEASUREMENTS ARE APPROX, NO
 REMOVAL UNTIL THURSDAY, DECEMBER 14TH)

3160 2-1/4" X 103" LIVE EDGE MAPLE SLAB
 (LARGE END
 12", SMALL END 11", MEASUREMENTS ARE APPROX,
 NO REMOVAL UNTIL THURSDAY, DECEMBER 14TH)

3161 2" X 93" LIVE EDGE MAPLE SLAB (LARGE
 END 10",
 SMALL END 6", MEASUREMENTS ARE APPROX, NO
 REMOVAL UNTIL THURSDAY, DECEMBER 14TH)

3162 2-1/4" X 103" LIVE EDGE MAPLE SLAB
 (LARGE END
 18", SMALL END 16", MEASUREMENTS ARE APPROX,
 NO REMOVAL UNTIL THURSDAY, DECEMBER 14TH)

3163 2-1/4" X 103" LIVE EDGE MAPLE SLAB
 (LARGE END
 19", SMALL END 16", MEASUREMENTS ARE APPROX,
 NO REMOVAL UNTIL THURSDAY, DECEMBER 14TH)

3164 2-1/4" X 103" LIVE EDGE MAPLE SLAB
 (LARGE END
 17", SMALL END 15", MEASUREMENTS ARE APPROX,
 NO REMOVAL UNTIL THURSDAY, DECEMBER 14TH)

3165 2-1/4" X 103" LIVE EDGE MAPLE SLAB
 (LARGE END
 14", SMALL END 13", MEASUREMENTS ARE APPROX,
 NO REMOVAL UNTIL THURSDAY, DECEMBER 14TH)

3166 2" X 67" LIVE EDGE CEDAR SLAB (LARGE
 END 13",
 SMALL END 6", MEASUREMENTS ARE APPROX, NO
 REMOVAL UNTIL THURSDAY, DECEMBER 14TH)

MARYSVILLE TOOLS & EQUIPMENT - ONLINE ONLY 12/1/2023-12/8/2023

LOT #

3167 2" X 67" LIVE EDGE CEDAR SLAB (LARGE
 END 9",
 SMALL END 8", MEASUREMENTS ARE APPROX, NO
 REMOVAL UNTIL THURSDAY, DECEMBER 14TH)

3168 2" X 67" LIVE EDGE WALNUT SLAB (LARGE
 END 12",
 SMALL END 8", MEASUREMENTS ARE APPROX, NO
 REMOVAL UNTIL THURSDAY, DECEMBER 14TH)

3169 2" X 77" LIVE EDGE WALNUT SLAB (LARGE
 END 13",
 SMALL END 6", MEASUREMENTS ARE APPROX, NO
 REMOVAL UNTIL THURSDAY, DECEMBER 14TH)

3170 2" X 84" LIVE EDGE WALNUT SLAB (LARGE
 END 10",
 SMALL END 9", MEASUREMENTS ARE APPROX, NO
 REMOVAL UNTIL THURSDAY, DECEMBER 14TH)

3171 2" X 86" LIVE EDGE WALNUT SLAB (LARGE
 END 13",
 SMALL END 12", MEASUREMENTS ARE APPROX, NO
 REMOVAL UNTIL THURSDAY, DECEMBER 14TH)

3172 2" X 80" LIVE EDGE WALNUT SLAB (LARGE
 END 14",
 SMALL END 6", MEASUREMENTS ARE APPROX, NO
 REMOVAL UNTIL THURSDAY, DECEMBER 14TH)

3173 2" X 74" LIVE EDGE CEDAR SLAB (LARGE
 END 15",
 SMALL END 13", MEASUREMENTS ARE APPROX, NO
 REMOVAL UNTIL THURSDAY, DECEMBER 14TH)

3174 2-1/2" X 122" LIVE EDGE REDWOOD SLAB
 (LARGE END
 39", SMALL END 21", MEASUREMENTS ARE APPROX,
 NO REMOVAL UNTIL THURSDAY, DECEMBER 14TH)

3175 2-3/4" X 122" LIVE EDGE REDWOOD SLAB
 (LARGE END
 40", SMALL END 30", MEASUREMENTS ARE APPROX,
 NO REMOVAL UNTIL THURSDAY, DECEMBER 14TH)

3176 2-3/4" X 122" LIVE EDGE REDWOOD SLAB
 (LARGE END
 40", SMALL END 33", MEASUREMENTS ARE APPROX,
 NO REMOVAL UNTIL THURSDAY, DECEMBER 14TH)

LOT #

3177 2-1/2" X 123" LIVE EDGE REDWOOD SLAB
 (LARGE END
 40", SMALL END 35", MEASUREMENTS ARE APPROX,
 NO REMOVAL UNTIL THURSDAY, DECEMBER 14TH)

3178 2-1/2" X 123" LIVE EDGE REDWOOD SLAB
 (LARGE END
 40", SMALL END 36", MEASUREMENTS ARE APPROX,
 NO REMOVAL UNTIL THURSDAY, DECEMBER 14TH)

3179 2-1/2" X 123" LIVE EDGE REDWOOD SLAB
 (LARGE END
 40", SMALL END 36", MEASUREMENTS ARE APPROX,
 NO REMOVAL UNTIL THURSDAY, DECEMBER 14TH)

3180 2-1/2" X 152" LIVE EDGE REDWOOD SLAB
 (LARGE END
 31", SMALL END 22", MEASUREMENTS ARE APPROX,
 NO REMOVAL UNTIL THURSDAY, DECEMBER 14TH)

3181 2-1/2" X 152" LIVE EDGE REDWOOD SLAB
 (LARGE END
 32", SMALL END 26", MEASUREMENTS ARE APPROX,
 NO REMOVAL UNTIL THURSDAY, DECEMBER 14TH)

3182 2-1/2" X 152" LIVE EDGE REDWOOD SLAB
 (LARGE END
 33", SMALL END 29", MEASUREMENTS ARE APPROX,
 NO REMOVAL UNTIL THURSDAY, DECEMBER 14TH)

3183 2-1/2" X 152" LIVE EDGE REDWOOD SLAB
 (LARGE END
 32", SMALL END 29", MEASUREMENTS ARE APPROX,
 NO REMOVAL UNTIL THURSDAY, DECEMBER 14TH)

3184 2-1/2" X 152" LIVE EDGE REDWOOD SLAB
 (LARGE END
 29", SMALL END 25", MEASUREMENTS ARE APPROX,
 NO REMOVAL UNTIL THURSDAY, DECEMBER 14TH)

3185 2-1/2" X 152" LIVE EDGE REDWOOD SLAB
 (LARGE END
 26", SMALL END 25", MEASUREMENTS ARE APPROX,
 NO REMOVAL UNTIL THURSDAY, DECEMBER 14TH)

MARYSVILLE TOOLS & EQUIPMENT - ONLINE ONLY 12/1/2023-12/8/2023

LOT #

3186 LOT, (2) 2-1/2" X 118" LIVE EDGE FIR
 SLABS (NO
 REMOVAL UNTIL THURSDAY, DECEMBER 14TH)

3187 LOT, (2) 2-1/2" X 118" LIVE EDGE FIR
 SLABS (NO
 REMOVAL UNTIL THURSDAY, DECEMBER 14TH)

3188 2-1/2" X 122" LIVE EDGE REDWOOD SLAB
 (LARGE END
 40", SMALL END 37", MEASUREMENTS ARE APPROX,
 NO REMOVAL UNTIL THURSDAY, DECEMBER 14TH)

3189 2-1/2" X 122" LIVE EDGE REDWOOD SLAB
 (LARGE END
 37", SMALL END 36", MEASUREMENTS ARE APPROX,
 NO REMOVAL UNTIL THURSDAY, DECEMBER 14TH)

3190 2-1/2" X 122" LIVE EDGE REDWOOD SLAB
 (LARGE END
 36", SMALL END 32", MEASUREMENTS ARE APPROX,
 NO REMOVAL UNTIL THURSDAY, DECEMBER 14TH)

3191 2-1/2" X 122" LIVE EDGE REDWOOD SLAB
 (LARGE END
 34", SMALL END 24", MEASUREMENTS ARE APPROX,
 NO REMOVAL UNTIL THURSDAY, DECEMBER 14TH)

3192 2-1/2" X 122" LIVE EDGE REDWOOD SLAB
 (LARGE END
 29", SMALL END 13", MEASUREMENTS ARE APPROX,
 NO REMOVAL UNTIL THURSDAY, DECEMBER 14TH)

3193 2-1/2" X 97" LIVE EDGE REDWOOD SLAB
 (LARGE END
 39", SMALL END 35", MEASUREMENTS ARE APPROX,
 NO REMOVAL UNTIL THURSDAY, DECEMBER 14TH)

3194 2-1/2" X 97" LIVE EDGE REDWOOD SLAB
 (LARGE END
 39", SMALL END 38", MEASUREMENTS ARE APPROX,
 NO REMOVAL UNTIL THURSDAY, DECEMBER 14TH)

3195 2-1/2" X 97" LIVE EDGE REDWOOD SLAB
 (LARGE END
 44", SMALL END 40", MEASUREMENTS ARE APPROX,
 NO REMOVAL UNTIL THURSDAY, DECEMBER 14TH)

LOT #

3196 2-1/2" X 95" LIVE EDGE REDWOOD SLAB
 (LARGE END
 45", SMALL END 43", MEASUREMENTS ARE APPROX,
 NO REMOVAL UNTIL THURSDAY, DECEMBER 14TH)

3197 2-1/2" X 95" LIVE EDGE REDWOOD SLAB
 (LARGE END
 46", SMALL END 43", MEASUREMENTS ARE APPROX,
 NO REMOVAL UNTIL THURSDAY, DECEMBER 14TH)

3198 2-1/2" X 95" LIVE EDGE REDWOOD SLAB
 (LARGE END
 47", SMALL END 44", MEASUREMENTS ARE APPROX,
 NO REMOVAL UNTIL THURSDAY, DECEMBER 14TH)

3199 2-1/2" X 95" LIVE EDGE REDWOOD SLAB
 (LARGE END
 47", SMALL END 44", MEASUREMENTS ARE APPROX,
 NO REMOVAL UNTIL THURSDAY, DECEMBER 14TH)

3200 2-1/2" X 95" LIVE EDGE REDWOOD SLAB
 (LARGE END
 46", SMALL END 44", MEASUREMENTS ARE APPROX,
 NO REMOVAL UNTIL THURSDAY, DECEMBER 14TH)

3201 2-1/2" X 95" LIVE EDGE REDWOOD SLAB
 (LARGE END
 44", SMALL END 43", MEASUREMENTS ARE APPROX,
 NO REMOVAL UNTIL THURSDAY, DECEMBER 14TH)

3202 2-1/2" X 95" LIVE EDGE REDWOOD SLAB
 (LARGE END
 42", SMALL END 41", MEASUREMENTS ARE APPROX,
 NO REMOVAL UNTIL THURSDAY, DECEMBER 14TH)

3203 2-1/2" X 95" LIVE EDGE REDWOOD SLAB
 (LARGE END
 38", SMALL END 35", MEASUREMENTS ARE APPROX,
 NO REMOVAL UNTIL THURSDAY, DECEMBER 14TH)

3204 LOT, ASSORTED DIMENSION 30-YEAR DRY
 GRENADILLO &
 HONDURAN MOHOGANY LUMBER AT VARIOUS
 LENGTHS FROM APPROX 4' TO 8' (NO REMOVAL
 UNTIL THURSDAY, DECEMBER 14TH)

MARYSVILLE TOOLS & EQUIPMENT - ONLINE ONLY 12/1/2023-12/8/2023

LOT #	LOT #
3205 LOT, ASSORTED DIMENSION 30-YEAR DRY TIGERWOOD LUMBER AT VARIOUS LENGTHS FROM APPROX 3' TO 11' (NO REMOVAL UNTIL THURSDAY, DECEMBER 14TH)	3214 LOT, (1) HAWAIIAN RAMBUTAN, (1) HAWAIIAN MAHOGANY & (2) HAWAIIAN MONKEY POD ASSORTED DIMENSION KILN DRIED LIVE EDGE WOOD SLABS (NO REMOVAL UNTIL THURSDAY, DECEMBER 14TH)
3206 LOT, ASSORTED DIMENSION 30-YEAR DRY ANGELUM PEDRA LUMBER AT VARIOUS LENGTHS FROM APPROX 3' TO 7' (NO REMOVAL UNTIL THURSDAY, DECEMBER 14TH)	3215 LOT, (1) ELM, (1) SYCAMORE & (1) WALNUT ASSORTED DIMENSION KILN DRIED LIVE EDGE WOOD SLABS (NO REMOVAL UNTIL THURSDAY, DECEMBER 14TH)
3207 LOT, (2) 2" X 127" LIVE EDGE CEDAR SLABS & ASSORTED KILN DRIED HONEY LOCUST ROUGH CUT LUMBER AT VARIOUS LENGTHS UP TO APPROX 10' (NO REMOVAL UNTIL THURSDAY, DECEMBER 14TH)	3216 LOT, (3) ASSORTED DIMENSION KILN DRIED LIVE EDGE ELM SLABS (NO REMOVAL UNTIL THURSDAY, DECEMBER 14TH)
3208 LOT, (3) ASSORTED DIMENSION KILN DRIED LIVE EDGE HAWAIIAN IRONWOOD SLABS (NO REMOVAL UNTIL THURSDAY, DECEMBER 14TH)	3217 LOT, (5) ASSORTED DIMENSION KILN DRIED LIVE EDGE MAPLE SLABS (NO REMOVAL UNTIL THURSDAY, DECEMBER 14TH)
3209 LOT, (5) ASSORTED DIMENSION KILN DRIED LIVE EDGE MAPLE SLABS (NO REMOVAL UNTIL THURSDAY, DECEMBER 14TH)	3218 LOT, (4) ASSORTED DIMENSION KILN DRIED LIVE EDGE MAPLE SLABS (NO REMOVAL UNTIL THURSDAY, DECEMBER 14TH)
3210 LOT, (4) ASSORTED DIMENSION KILN DRIED LIVE EDGE CUBAN MAHOGANY SLABS (NO REMOVAL UNTIL THURSDAY, DECEMBER 14TH)	3219 LOT, (5) ASSORTED DIMENSION KILN DRIED LIVE EDGE MAPLE SLABS (NO REMOVAL UNTIL THURSDAY, DECEMBER 14TH)
3211 LOT, (4) ASSORTED DIMENSION KILN DRIED LIVE EDGE CUBAN MAHOGANY SLABS (NO REMOVAL UNTIL THURSDAY, DECEMBER 14TH)	3220 LOT, (3) ASSORTED DIMENSION LIVE EDGE MAPLE SLABS (NO REMOVAL UNTIL THURSDAY, DECEMBER 14TH)
3212 LOT, (4) ASSORTED DIMENSION KILN DRIED LIVE EDGE CUBAN MAHOGANY SLABS (NO REMOVAL UNTIL THURSDAY, DECEMBER 14TH)	3221 LOT, (3) ASSORTED DIMENSION LIVE EDGE WALNUT SLABS (NO REMOVAL UNTIL THURSDAY, DECEMBER 14TH)
3213 LOT, (2) HONEY LOCUST & (1) PACIFIC YEW ASSORTED DIMENSION KILN DRIED WOOD SLABS (NO REMOVAL UNTIL THURSDAY, DECEMBER 14TH)	3222 LOT, (3) ASSORTED DIMENSION LIVE EDGE WALNUT SLABS (NO REMOVAL UNTIL THURSDAY, DECEMBER 14TH)

13% BUYERS PREMIUM ON ALL ITEMS

LOT #

3223 LOT, (3) ASSORTED DIMENSION KILN DRIED
LIVE EDGE
CEDAR SLABS (NO REMOVAL UNTIL THURSDAY,
DECEMBER 14TH)

3224 LOT, ASSORTED DIMENSION KILN DRIED
LIVE EDGE
MAPLE SLABS (NO REMOVAL UNTIL THURSDAY,
DECEMBER 14TH)

3225 LOT, (3) ASSORTED DIMENSION LIVE EDGE
WALNUT

SLABS (NO REMOVAL UNTIL THURSDAY,
DECEMBER 14TH)
